

DEPARTMENT OF THE ARMY PERMIT

Permittee: Albany Port District Commission
Attention: Mr. Richard Hendrick, Chief Executive Officer
106 Smith Boulevard
Albany, New York 12202
(518) 463-2164

Permit Number: NAN-2021-00948-UDA

Date Issued: APR 10 2023

Issuing Office: U.S. Army Corps of Engineers, New York District

NOTE: The term "you" and its derivatives, as used in this permit, means the permittee or any future transferee. The term "this office" refers to the appropriate district or division office of the Corps of Engineers having jurisdiction over the permitted activity or the appropriate official of that office acting under the authority of the commanding officer.

You are authorized to perform work in accordance with the terms and conditions specified below.

Project Description: Dredging, with 10-years maintenance, of approximately 80,000 cubic yards (cy) of material via a barge-mounted crane with a closed clamshell bucket, from a 2.62-acre area of riverbed to a depth of 32 feet (ft) below the plane of the mean low water (MLW) with 2 ft over dredge to 34 ft. MLW. Double-walled silt curtains will be installed during the entire dredging operation. The dredged material will be placed into scows and will be allowed to settle in the scows before the water is decanted and discharged back into the Hudson River. Once the material has been decanted, the scows will be shipped via tug to the Clean Earth Clermont Dredged Processing Facility (Facility I.D. 215.734.1400), located at One Linden Avenue East, Jersey City, New Jersey for amendment and trucking to an upland disposal site.

A new wharf, 500 ft long by 93 ft wide, will be constructed along the west bank of the Hudson River. The wharf will consist of a heavy stone slope revetment, a high-modulus steel sheet pile cutoff wall, and a drilled shaft supported open wharf and relieving platform. Structures and fill installed below mean high high water elevation include 136, 48-inch diameter drilled shaft foundations with permanent steel casing, and approximately 1,162 CY of rip rap. Approximately 263 CY of the rip rap would be placed below mean high water elevation. The permanent steel casing for the drilled shaft foundations and the sheet pile wall components will be vibrated in, rather than utilizing an impact hammer. An impact hammer will only be used to seat the steel casing within the first few inches in the top of rock.

A new, 3-span bridge will be constructed over the Normans Kill channel. The bridge will be constructed on two (2) reinforced concrete drilled shafts. The construction of the northern shaft will require the discharge of fill material into 0.04-acre of wetland.

PERMITTEE: Albany Port District Commission
PERMIT NO.: NAN-2021-00948-UDA

Five new warehouse and manufacturing buildings totaling approximately 626,014 (SF) and associated attendant features including roadways, parking areas, utilities, an approximately 822 linear foot retaining wall, a wastewater treatment facility, stormwater management features and associated treated runoff outfalls to the Hudson River will be constructed. The construction of the warehouse and manufacturing buildings and attendant features will require the discharge of fill material into total of 0.81-acre of wetlands, comprised of approximately 0.30-acre of palustrine emergent wetland and 0.51-acre of palustrine forested wetland, respectively. In addition, a maximum of 0.33-acre of palustrine forested wetland will be permanently converted to an emergent cover type to facilitate the construction of the new buildings and attendant features. An 18-inch diameter water intake pipe and associated screening will be installed within the Hudson River.

To mitigate for unavoidable impacts to waters of the United States, the applicant shall purchase a total of 2.57 credits from the Middle Hudson Service Area of the Ducks Unlimited New York In-Lieu Fee Program, secure a restrictive covenant over 1,700 liner feet of on-site riparian buffer along the Hudson River, and implement a submerged aquatic vegetation transplantation and monitoring effort.

All work shall be performed in accordance with the attached drawings and Special Conditions (A) through (R) listed below, all which are hereby made a part of this permit.

Project Location: IN: Hudson River
AT: City of Albany and Town of Bethlehem, Albany County, New York

Permit Conditions:

General Conditions:

1. The time limit for completing the work authorized ends on April 10, 2033. If you find that you need more time to complete the authorized activity, submit your request for a time extension to this office for consideration at least one month before the above date is reached.
2. You must maintain the activity authorized by this permit in good condition and in conformance with the terms and conditions of this permit. You are not relieved of this requirement if you abandon the permitted activity, although you may make a good faith transfer to a third party in compliance with General Condition 4 below. Should you wish to cease to maintain the authorized activity or should you desire to abandon it without a good faith transfer, you must obtain a modification of this permit from this office, which may require restoration of the area.
3. If you discover any previously unknown historic or archeological remains while accomplishing the activity authorized by this permit, you must immediately notify this office of what you have

PERMITTEE: Albany Port District Commission
PERMIT NO.: NAN-2021-00948-UDA

found. We will initiate the Federal and state coordination required to determine if the remains warrant a recovery effort or if the site is eligible for listing in the National Register of Historic Places.

4. If you sell the property associated with this permit, you must obtain the signature of the new owner in the space provided and forward a copy of the permit to this office to validate the transfer of this authorization.

5. If a conditioned water quality certification has been issued for your project, you must comply with the conditions specified in the certification as special conditions to this permit. For your convenience, a copy of the certification is attached if it contains such conditions.

6. You must allow representatives from this office to inspect the authorized activity at any time deemed necessary to ensure that it is being or has been accomplished in accordance with the terms and conditions of your permit.

Special Conditions:

(A) The permittee shall submit to this office the dates of commencement and completion of the herein authorized activities on the attached forms.

(B) The permittee, and its agents, shall conduct all dredging activities from September 1st through December 31st of any calendar year in order to minimize adverse aquatic impacts to diadromous fish spawning migrations and their peak biological activity, and impacts to Shortnose sturgeon (*Acipenser brevirostrum*) and Atlantic sturgeon (*A. oxyrinchus*).

(C) The permittee shall install a weighted double-walled silt curtain during dredging operations.

(D) The permittee shall maintain a copy of this permit on all vessels engaged in dredging and transporting dredged materials.

(E) The permittee shall undertake all dredging activities in such a manner as to avoid large refuse piles, ridges across the bed of the waterway or deep holes, which have a tendency to cause injury to navigable channels or the banks of the waterway.

(F) If any portion of the Federal Navigation Channel affected by contractor operations, then it must be restored to its project depth (32' MLLW), with the side slope (1H3V) also restored. In addition, the permittee shall perform hydrographic surveys of the federal navigation channel adjacent to the worksite upon completion of work. The survey shall be submitted to the Regulatory Branch Upstate Regulatory Field Office within 30 days of the completion of the activity authorized by this permit verification.

PERMITTEE: Albany Port District Commission
PERMIT NO.: NAN-2021-00948-UDA

(G) The permittee shall, no less than fourteen (14) days prior to the commencement of any dredging, notify the United States Coast Guard office (USCG) of the commencement of any dredging and expected completion date, the hours of the day the work will be performed, the names of the vessels on-scene, the VHF radio channel(s) the vessels will monitor, and the project's 24/7 point(s) of contact. This information may be emailed to SECTORNYWWM@uscg.mil.

(H) No less than 14 days prior to the commencement of any in-water work, the permittee shall inform local waterway users of the commencement of the work, using the "Local Notice to Mariners." Information required to be provided in the Local Notice to Mariners can be found at <http://www.navcen.uscg.gov>. This information may be e-mailed to D01-SMB-LNM@uscg.mil.

(I) The permittee shall provide the National Oceanic and Atmospheric Administration National Ocean Service (NOAA-NOS) of the project's physical completion date and as-built specifications so that NOAA may initiate the appropriate navigation chart updates and corrections. This information must be submitted online at:

<http://ocsddata.ncd.noaa.gov/idrs/discrepancy.aspx>

(J) The permittee shall verify, in writing, compliance with all required notices to USCG and NOAA-NOS as called for above, within five (5) calendar days of each notice. Verifications shall include the permit number (NAN-2021-00948-UDA) and be delivered to the New York District by email at cenan.rfo@usace.army.mil (preferred) or to the following address:

**DEPARTMENT OF THE ARMY
US Army Corps of Engineers
ATTN: CENAN-OP-RU
Upstate New York Section
1 Buffington St., Bldg. 10, 3rd Fl. North
Watervliet, New York 12189-4000**

(K) The permittee understands and agrees that, if future operations by the United States require the removal, relocation, or other alteration, of the structure or work herein authorized, or if, in the opinion of the Secretary of the Army or his authorized representative, said structure or work shall cause unreasonable obstruction to the free navigation of the navigable waters, the permittee will be required, upon due notice from the Corps of Engineers, to remove, relocate, or alter the structural work or obstructions caused thereby, without expense to the United States. No claim shall be made against the United States on account of any such removal or alteration.

(L) Outdoor lighting shall be located or shielded so that it is not confused with any aids to navigation and does not interfere with navigation on the adjacent waterway.

(M) The permittee shall ensure The Federal Navigation Channel will remain clear of any barges, vessels, and/or floating equipment. Any equipment staged within the channel must be temporary, and their placement will be coordinated with the USACE Albany Field Office and USCG.

(N) Within sixty (60) days of the effective date of this permit, the permittee shall submit to the New York District, U.S Army Corps of Engineers and the National Oceanic and Atmospheric Administration National Marine Fisheries, a final version of the document entitled "Port of Albany Compensatory SAV Mitigation Plan - Draft", dated January 9, 2023, and prepared AKRF, Inc., for review and approval. The mitigation measures outline in the draft plan shall not be implemented until approved in writing by the U.S. Army Corps of Engineers. No dredging associated with the project shall be conducted until the mitigation plan has been approved in writing, and the 0.21-acre of SAV has been transplanted in accordance with the plan.

(O) The permittee shall accomplish compensatory mitigation through the purchase of 2.57 credits from the Middle Hudson Service Area of the Ducks Unlimited New York In-Lieu Fee Program (HUC 02020006 & ~35 square mile section of HUC 01100005). Within thirty (30) days of the effective date of this permit, the permittee shall supply this office with a copy of the signed Credit Sale Letter verifying acceptance of full payment by Ducks Unlimited New York In-Lieu Fee Program for the appropriate credits.

(P) The permittee shall secure restrictive covenants on the 2.87-acre riparian buffer to guarantee their preservation for wetland and wildlife resources. Within thirty (30) days from the effective date of this permit, the permittee shall accomplish the preservation of these areas by properly executing and filing the restrictive covenant, as described in the draft received by this office on July 5, 2022, with the Recorder of Deeds for Albany County and shall provide to this office a copy of the documents, as filed in County records, within thirty (30) days of its filing.

(Q) Within sixty (60) days of the effective date of this permit, the permittee shall submit the final dredge plan to this office for review and written approval.

(R) The permittee shall undertake the authorized filling activities in a manner aimed at reducing impacts upon the general environment. In addition, the permittee shall not stockpile fill or other materials in a manner conducive to erosion, or in areas likely to cause high turbidity runoff during storm events. All exposed soils shall be re-vegetated in a timely manner to further reduce potential effects. The permittee shall also fence off all wetlands and other sensitive ecological areas during construction periods to prevent equipment and personnel from entering these areas.

PERMITTEE: Albany Port District Commission
PERMIT NO.: NAN-2021-00948-UDA

(S) The permittee shall ensure that all synthetic erosion control features (e.g., silt fencing, netting, mats), which are intended for temporary use during construction, are completely removed and properly disposed of after their initial purpose has been served. Only natural fiber materials, which will degrade after time, may be used as permanent measures, or if used temporarily, may be abandoned in place.

Further Information:

1. Congressional Authorities: You have been authorized to undertake the activity described above pursuant to:

(X) Section 10 of the Rivers and Harbors Act of 1899 (33 U.S. Code 403).

(X) Section 404 of the Clean Water Act (33 U.S. Code 1344).

() Section 103 of the Marine Protection, Research and Sanctuaries Act of 1972 (33 U.S.C. 1413).

2. Limits of this authorization:

a. This permit does not obviate the need to obtain other Federal, state, or local authorizations required by law.

b. This permit does not grant any property rights or exclusive privileges.

c. This permit does not authorize any injury to the property or rights of others.

d. This permit does not authorize interference with any existing or proposed Federal project.

3. Limits of Federal Liability: In issuing this permit, the Federal Government does not assume any liability for the following:

a. Damages to the permitted project or uses thereof as a result of other permitted or unpermitted activities or from natural causes.

b. Damages to the permitted project or uses thereof as a result of current or future activities undertaken by or on behalf of the United States in the public interest.

c. Damages to persons, property, or to other permitted or unpermitted activities or structures caused by the activity authorized by this permit.

d. Design or construction deficiencies associated with the permitted work.

PERMITTEE: Albany Port District Commission
PERMIT NO.: NAN-2021-00948-UDA

e. **Damage claims associated with any future modification, suspension, or revocation of this permit.**

4. Reliance on Applicant's Data: The determination of this office that issuance of this permit is not contrary to the public interest was made in reliance on the information you provided.

5. Reevaluation of Permit Decision: This office may reevaluate its decision on this permit at any time the circumstances warrant. Circumstances that could require a reevaluation include, but are not limited to, the following:

a. **You fail to comply with the terms and conditions of this permit.**

b. **The information provided by you in support of your permit application proves to have been false, incomplete, or inaccurate (See 4 above).**

c. **Significant new information surfaces which this office did not consider in reaching the original public interest decision.**

Such a reevaluation may result in a determination that it is appropriate to use the suspension, modification, and revocation procedures contained in 33 CFR 325.7 or enforcement procedures such as those contained in 33 CFR 326.4 and 326.5. The referenced enforcement procedures provide for the issuance of an administrative order requiring you to comply with the terms and conditions of your permit and for the initiation of legal action where appropriate. You will be required to pay for any corrective measures ordered by this office, and if you fail to comply with such directive, this office may in certain situations (such as those specified in 33 CFR 209.170) accomplish the corrective measures by contract or otherwise and bill you for the cost.

6. Extensions: General Condition 1 establishes a time limit for the completion of the activity authorized by this permit. Unless there are circumstances requiring either a prompt completion of the authorized activity or a reevaluation of the public interest decision, the Corps will normally give favorable consideration to a request for an extension of this time limit.

PERMITTEE: Albany Port District Commission
PERMIT NO.: NAN-2021-00948-UDA

Your signature below, as permittee, indicates that you accept and agree to comply with the terms and conditions of this permit.

Richard J Mendicino
(PERMITTEE)

APRIL 6, 2023
(DATE)

This permit becomes effective when the Federal official, designated to act for the Secretary of the Army, has signed below.

Stephan R. ...
(DISTRICT ENGINEER)

APR 10 2023
(DATE)

For and in behalf of
Matthew W. Luzzatto
Colonel, U.S. Army
Commander and District Engineer

When the structures or work authorized by this permit are still in existence at the time the property is transferred, the terms and conditions of this permit will continue to be binding on the new owner(s) of the property. To validate the transfer of this permit and the associated liabilities associated with compliance with its terms and conditions, have the transferee sign and date below. A copy of the permit signed by the transferee should be sent to this office.

(TRANSFEREE)

(DATE)

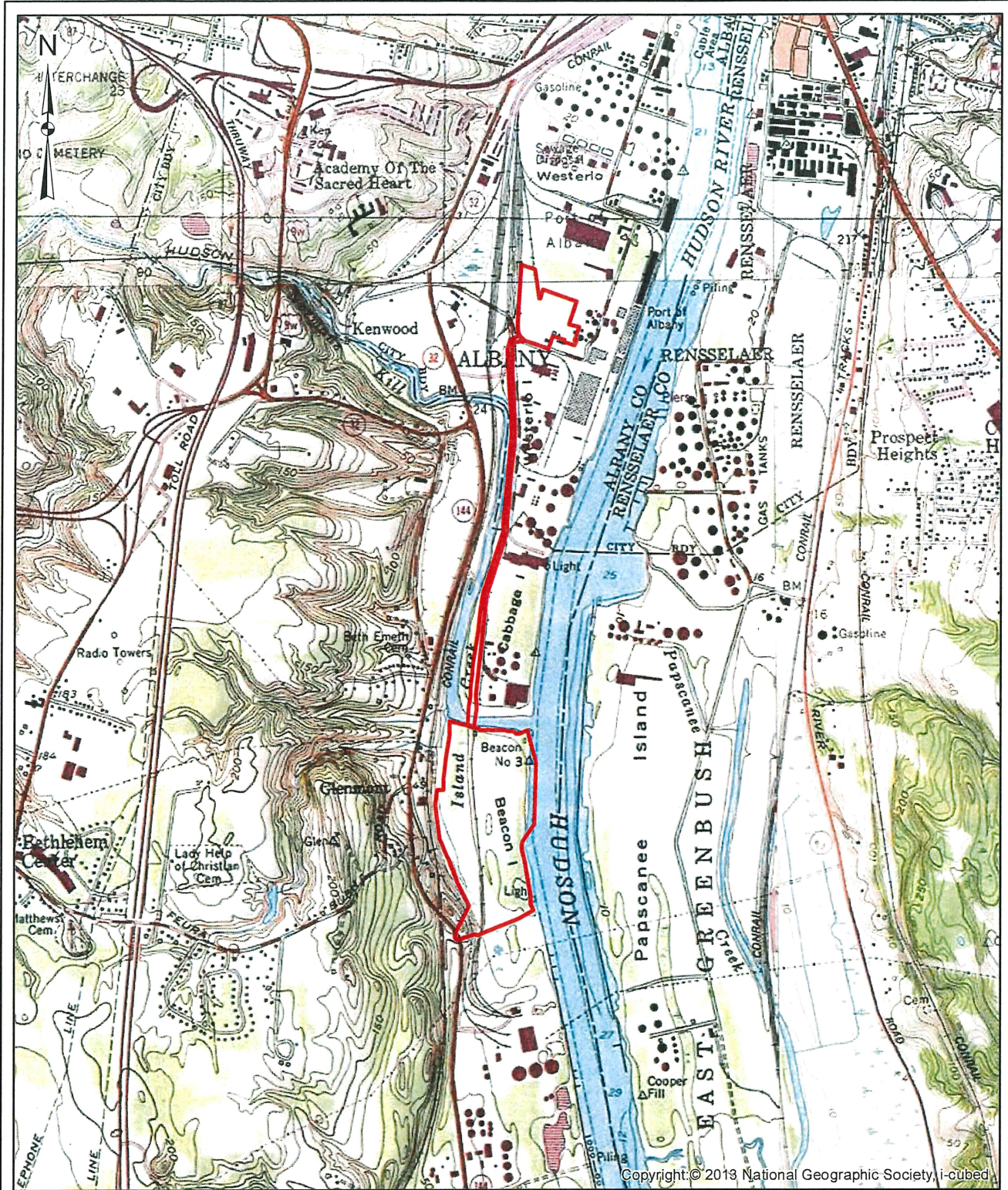

N:\18641.00 Albany Port Expansion\Draw\GIS\Supplemental Enviro 2021\Figure 2-1 - USGS Topo.mxd

Legend

Project Site

- Notes:
- 1) Project boundary is approximate
 - 2) All areas are approximate

PORT OF ALBANY DEVELOPMENT
TOWN OF BETHLEHEM, ALBANY COUNTY, NEW YORK

USGS TOPOGRAPHIC MAP

SCALE: AS SHOWN	DATE: JULY 2021	FIGURE: 2-1
--------------------	--------------------	----------------



McFarland Johnson
 80 PALMAD PLACE
 SUITE 402
 ALBANY, NY 12207
 518-486-4886
 518-486-8333
 SARATOGA@MCMJ.COM

PROJECT NUMBER: PERMIT SKETCHES

NO.	DATE	DESCRIPTION	BY	CHKD	REVISIONS
1	12/15/22	ISSUE FOR PERMIT			
2	12/15/22	FOR PUBLIC REVIEW			
3	12/15/22	FOR PUBLIC REVIEW			

CLIENT: ALBANY PORT DISTRICT COMMISSION
 PROJECT: ALBANY, NEW YORK
 PORT OF ALBANY EXPANSION SITE

DRAWN: NSD
 CHECKED: NSD
 DATE: MAY 2022
 PROJECT: 1841.00

SCALE: 1"=100'
 DATE: MAY 2022
 PROJECT: 1841.00

DRAWING TITLE: SITE PLAN OVERALL
 DRAWING NUMBER: SP-01
 1 OF 18

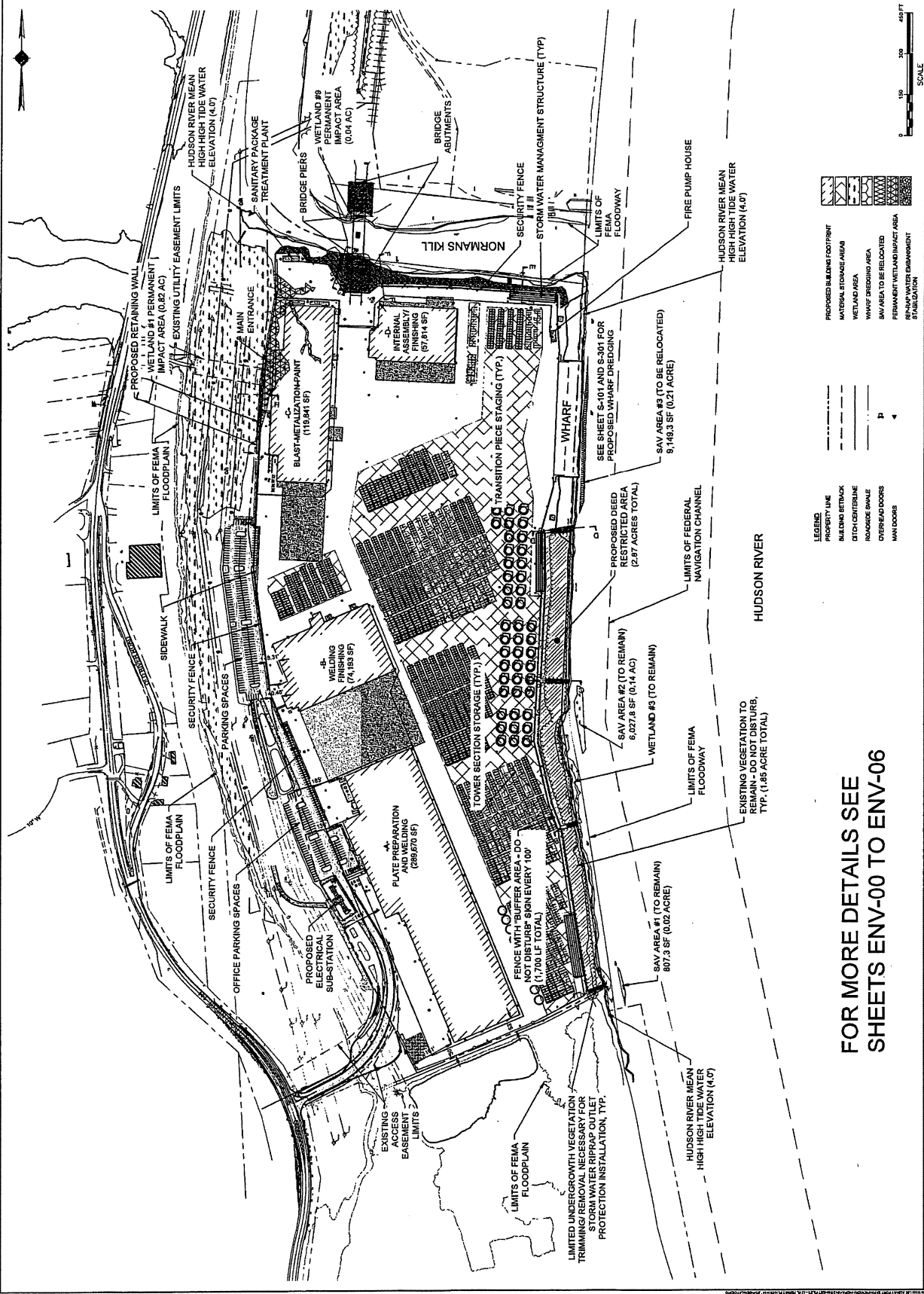

NAN-2021-00948-JDA

Albany Port District Commission

PERMIT SKETCHES

REV	DATE	DESCRIPTION

CLIENT: ALBANY PORT DISTRICT COMMISSION
 PROJECT: ALBANY, NEW YORK
 PROJECT: PORT OF ALBANY EXPANSION SITE

DRAWN: JES
 DESIGNED: RSD
 CHECKED: AJF
 SCALE: 1"=200'
 DATE: MAY 2022
 PROJECT: 1864.00

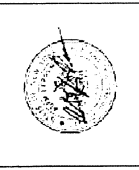

ENVIRONMENTAL PLAN NOTES & INDEX
 DRAWING NUMBER: ENV-00
 2 OF 18

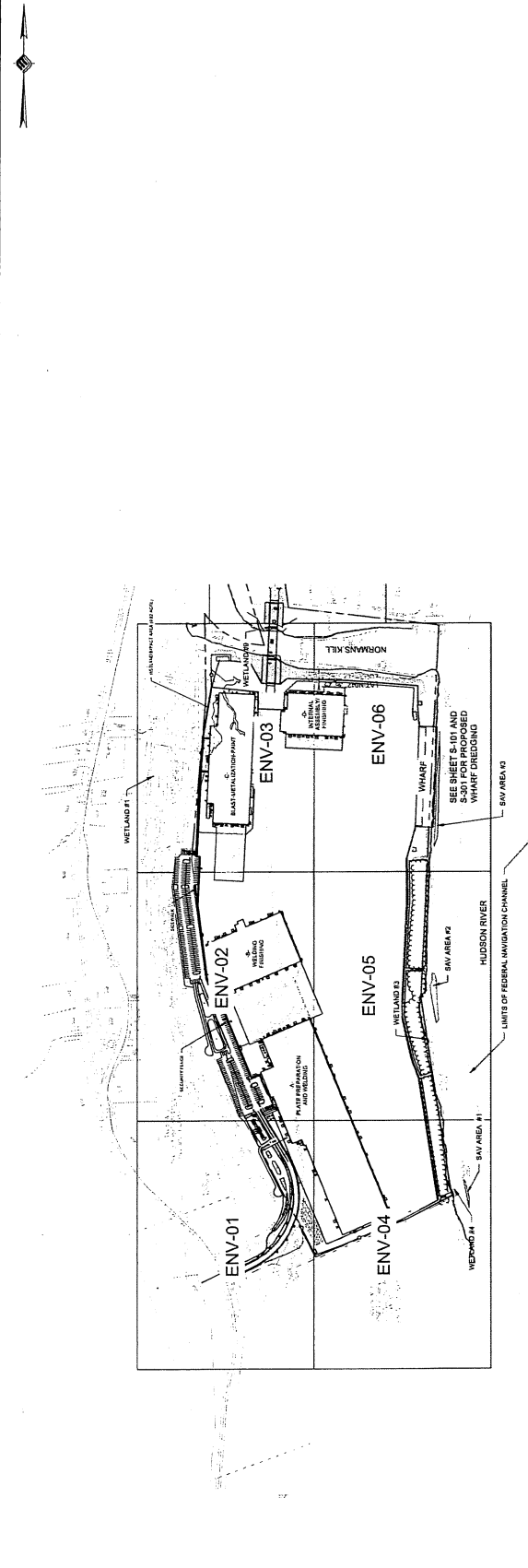

EROSION CONTROL

1. ALL PIPE PIPES SHALL FOLLOW IN/OUTROBOT SECTION 6932 AND 705-12, BE SMOOTH INTERIOR.
2. ALL PIPE PIPES SHALL FOLLOW IN/OUTROBOT SECTION 6932 AND 705-12, BE SMOOTH INTERIOR.
3. IN/OUTROBOT WHERE THE TOLERANCES EXCEEDS THE SANITARY SEWER A CORNERED STONE ENCLOSURE SHALL BE PROVIDED AROUND THE SANITARY SEWER UP TO THE STORM SEWER CONTACT WITH APPROVED EQUIPMENT.
4. ALL CONTACT BANKS AND ITERRIMMHOLES WITHIN PAVEMENT TO BE CONSTRUCTED TO WITHSTAND 2500 LB/FT².
5. THE CONTRACTOR SHALL BE RESPONSIBLE FOR RESTORATION OF TOPSOIL TO MAINTAIN EROSION CONTROL THROUGHOUT ALL TIMES.
6. ALL DISTURBED AREAS SHALL BE RESTORED TO ORIGINAL OR BETTER CONDITION WITH THE NEW YORK STATE DEPARTMENT OF ENVIRONMENTAL CONSERVATION, AGRICULTURE AND MARKETS DIVISION, AND THE TOWN OF BELLEVILLE RECOMMENDATIONS.
7. ALL INLETS TO THE STORM SEWER SHALL HAVE STONE DROP INLET PROTECTION. THE CONTRACTOR SHALL BE RESPONSIBLE FOR MAINTAINING BEST MANAGEMENT PRACTICES (BMP'S) UNTIL GROUND COVER IS ESTABLISHED.
8. ALL INLETS TO THE STORM SEWER SHALL HAVE STONE DROP INLET PROTECTION. THE CONTRACTOR SHALL BE RESPONSIBLE FOR MAINTAINING BEST MANAGEMENT PRACTICES (BMP'S) UNTIL GROUND COVER IS ESTABLISHED.
9. THE CONTRACTOR SHALL BE RESPONSIBLE FOR MAINTAINING BEST MANAGEMENT PRACTICES (BMP'S) UNTIL GROUND COVER IS ESTABLISHED.
10. ALL PROPOSED ELEVATIONS SHOWN HEREON ARE FINISHED GRADE ELEVATION. RELATION TO PROPOSED GRADE PRIOR TO INSTALLATION.

STORM SEWER

1. ALL PIPE PIPES SHALL FOLLOW IN/OUTROBOT SECTION 6932 AND 705-12, BE SMOOTH INTERIOR.
2. ALL PIPE PIPES SHALL FOLLOW IN/OUTROBOT SECTION 6932 AND 705-12, BE SMOOTH INTERIOR.
3. IN/OUTROBOT WHERE THE TOLERANCES EXCEEDS THE SANITARY SEWER A CORNERED STONE ENCLOSURE SHALL BE PROVIDED AROUND THE SANITARY SEWER UP TO THE STORM SEWER CONTACT WITH APPROVED EQUIPMENT.
4. ALL CONTACT BANKS AND ITERRIMMHOLES WITHIN PAVEMENT TO BE CONSTRUCTED TO WITHSTAND 2500 LB/FT².

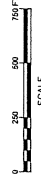
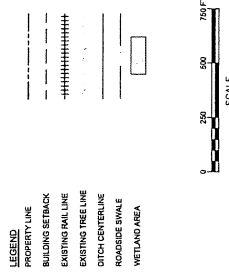

PROJECT: ALBANY PORT DISTRICT COMMISSION

PROJECT TITLE: PERMIT SKETCHES

REV.	DATE	DESCRIPTION

CLIENT: ALBANY PORT DISTRICT COMMISSION

PROJECT: ALBANY, NEW YORK

PROJECT TITLE: PORT OF ALBANY EXPANSION SITE

DRAWN	JES
CHECKED	NSD
DATE	11-20-22
PROJECT	18841.00

IF A PORTION OF ANY OF THE ABOVE IS NOT TO BE CONSIDERED FOR PERMITTING PURPOSES, THE ENGINEER WILL BE RESPONSIBLE FOR IDENTIFYING THE PORTION TO BE EXCLUDED FROM THE PERMITTING PROCESS AND FOR PROVIDING THE NECESSARY NOTES TO THE PERMITTING AGENCIES. THIS PLAN IS A PRELIMINARY DESIGN AND IS NOT TO BE USED FOR CONSTRUCTION WITHOUT THE NECESSARY APPROVALS FROM THE PERMITTING AGENCIES.

DRAWING TITLE: ENVIRONMENTAL PLAN

DRAWING NUMBER: ENV-01

3 OF 19

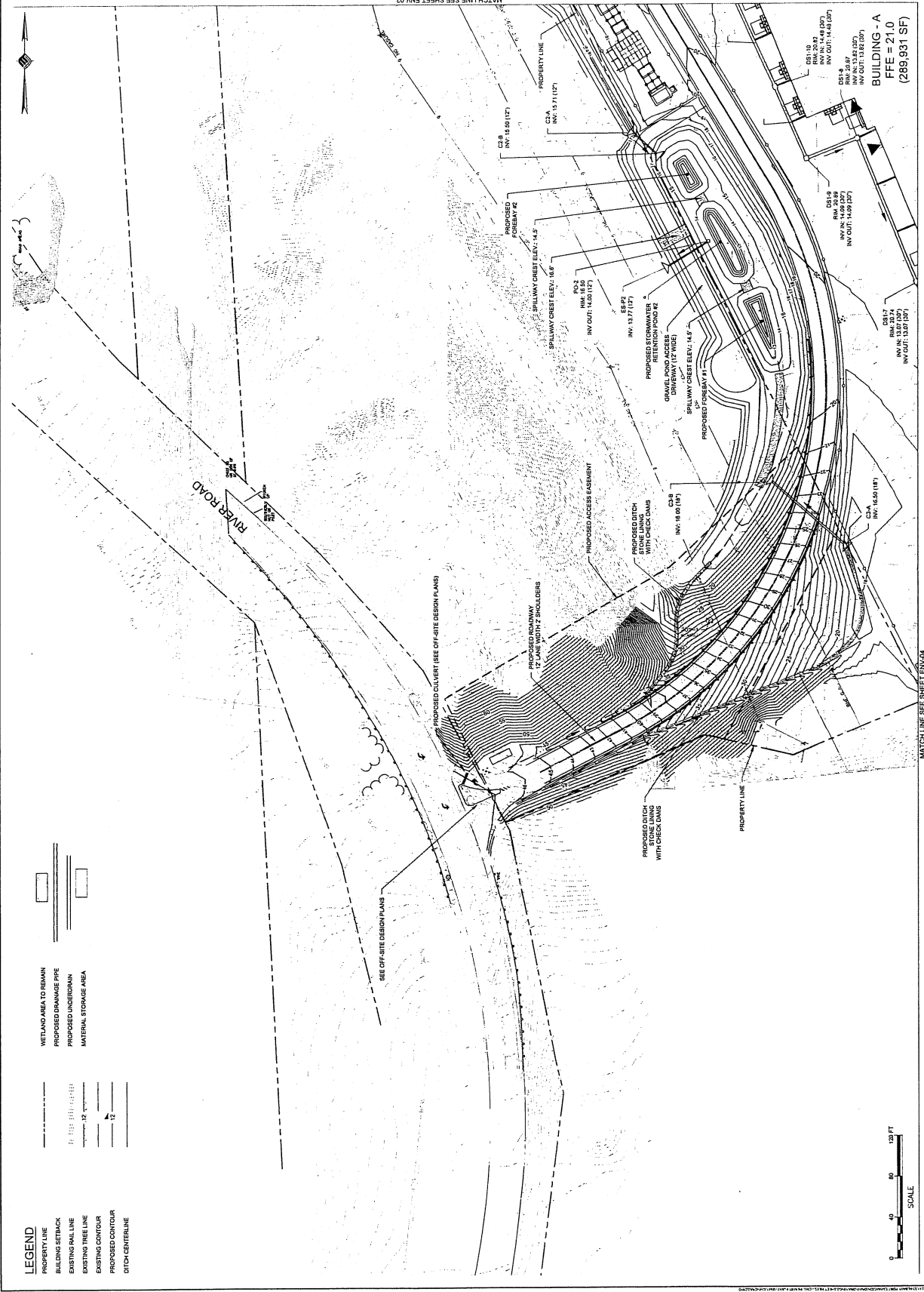

McFarland Johnson
 60 RAHWOOD PLACE
 SAUNTOON SPRINGS, NEW YORK 12966
 P 518-850-8380 F 518-860-0383
 SAUNTOON@MJCINC.COM

PROJECT TALENTONE
 PERMIT SKETCHES
 NO. DATE DESCRIPTION

CLIENT: ALBANY PORT DISTRICT COMMISSION
 PROJECT: ALBANY, NEW YORK
 PORT OF ALBANY EXPANSION SITE

DRAWN: JES
 DESIGNED: RMD
 CHECKED: AJF
 SCALE: 1"=40'
 DATE: MAY 2022
 PROJECT: 1004.105

ENVIRONMENTAL PLAN
 DRAWING NUMBER: ENV-02

1 OF 18

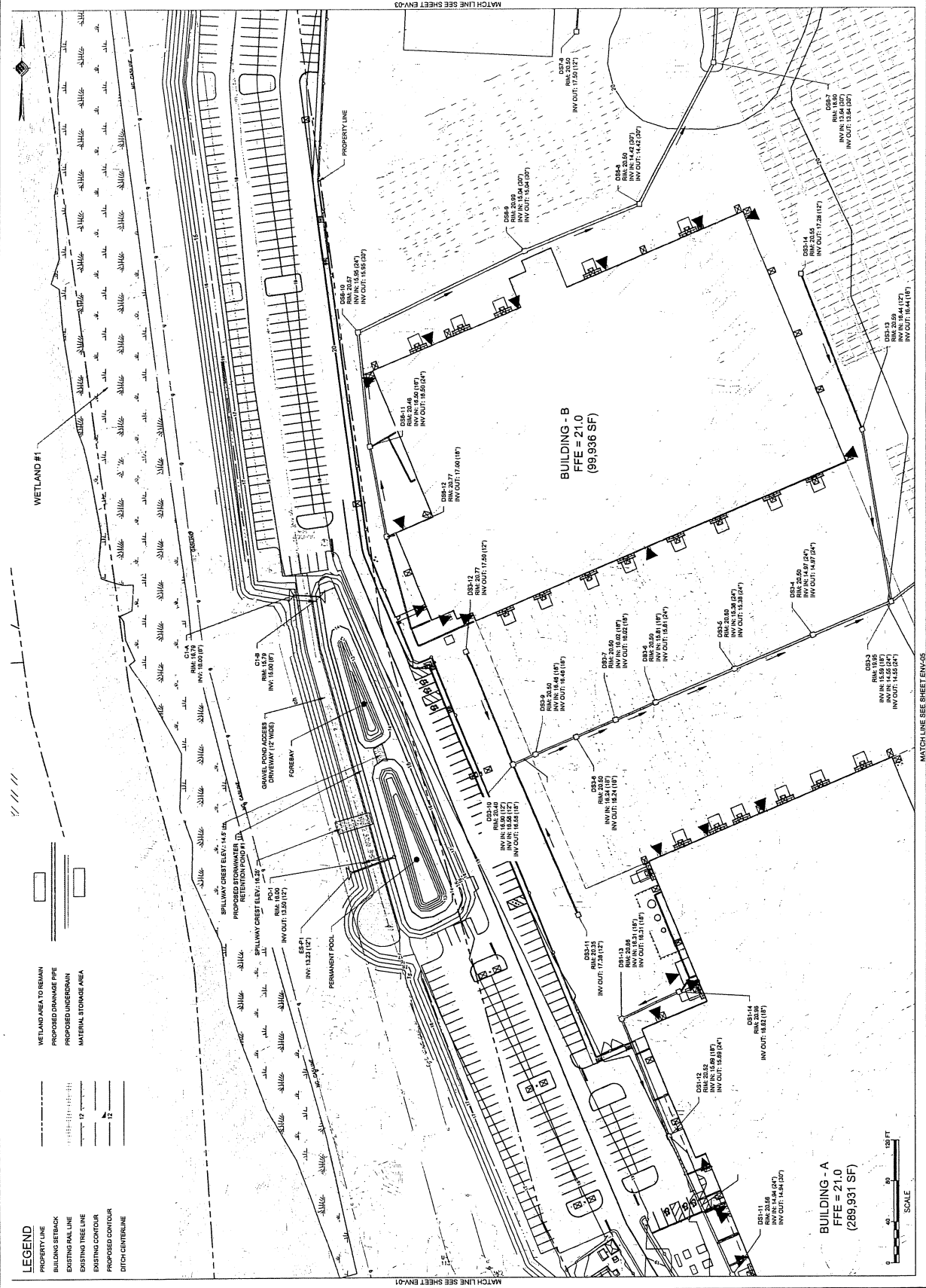

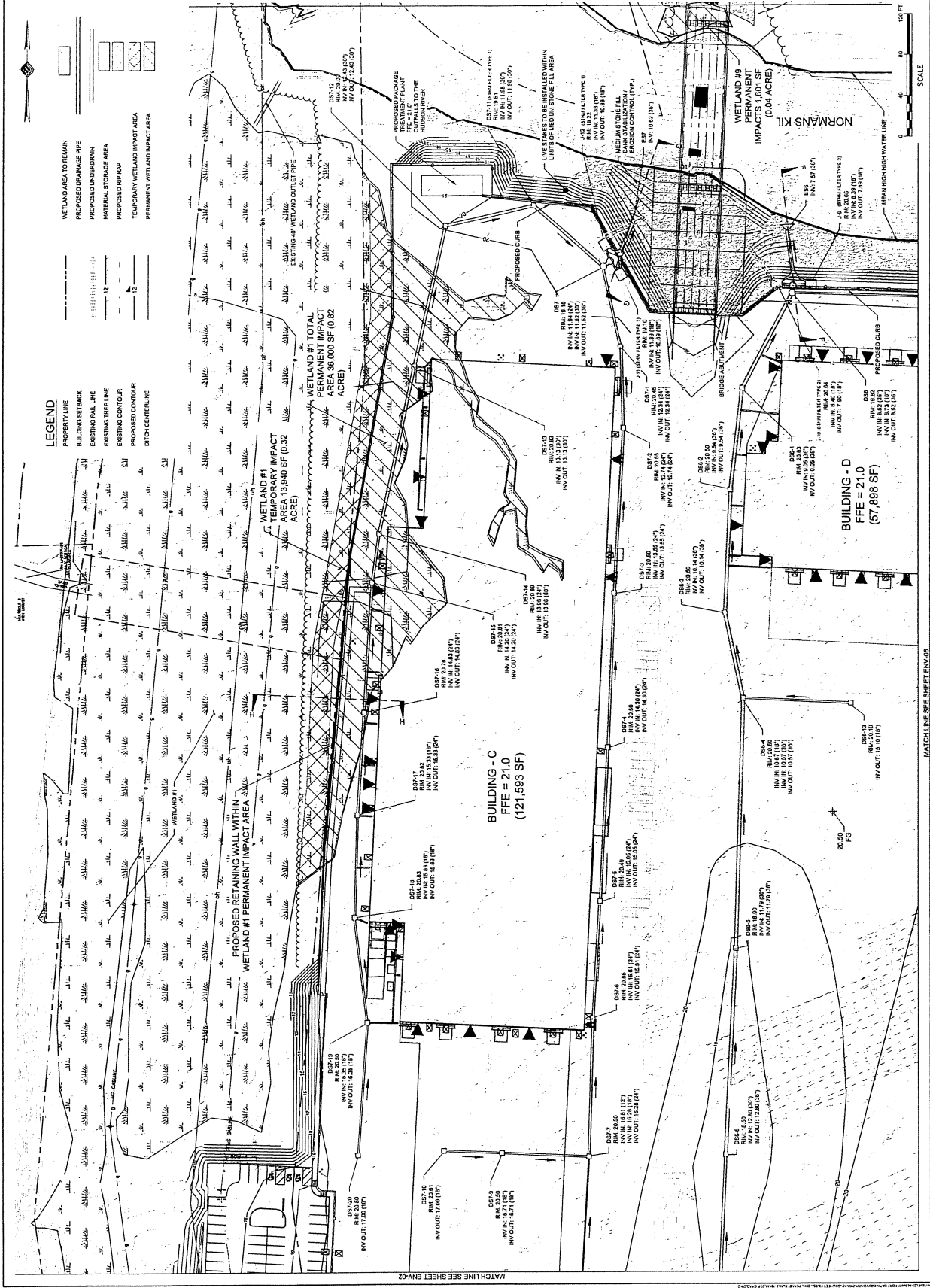

McFarland Johnson
 87 WALDOB PLACE
 SAUGTUCK SPRINGS, NEW YORK 12686
 P 516-850-9380 F 516-850-9383
 Smaugh@mcjeng.com

PERMIT SKETCHES		
NO.	DATE	DESCRIPTION

CLIENT:	ALBANY PORT DISTRICT COMMISSION
PROJECT:	PORT OF ALBANY EXPANSION SITE
ALBANY, NEW YORK	
DESIGNED:	JES
CHECKED:	MSD
SCALE:	AJF
DATE:	1"=40'
PROJECT:	MAY 2022
DRAWING NUMBER:	ENV-03
DRAWING TITLE:	ENVIRONMENTAL PLAN
SCALE:	5' OF 16'

IF A PORTION OF ANY OF THE WETLANDS, WETLANDS, OR OTHER FEATURES SHOWN ON THIS PLAN ARE FOUND TO BE AFFECTED BY ANY FEDERAL, STATE, OR LOCAL LAW, REGULATION, OR ORDER, THE DESIGNER SHALL BE RESPONSIBLE FOR OBTAINING ALL NECESSARY PERMITS AND APPROVALS FROM THE APPLICABLE AGENCIES. THE DESIGNER SHALL BE RESPONSIBLE FOR OBTAINING ALL NECESSARY PERMITS AND APPROVALS FROM THE APPLICABLE AGENCIES. THE DESIGNER SHALL BE RESPONSIBLE FOR OBTAINING ALL NECESSARY PERMITS AND APPROVALS FROM THE APPLICABLE AGENCIES.

NO.	DATE	DESCRIPTION

ALBANY PORT DISTRICT COMMISSION
ALBANY, NEW YORK
PORT OF ALBANY EXPANSION SITE

CLIENT: PROJECT:
 DESIGNED: JES
 CHECKED: JMS
 SCALE: 1"=40'
 DATE: MAY 2022
 PROJECT: 1804.00

ENVIRONMENTAL PLAN

DRAWING NUMBER: ENV-04
 6 OF 18

DRAWING TITLE: ENVIRONMENTAL PLAN

THIS DRAWING IS THE PROPERTY OF MCFARLAND JOHNSON & ASSOCIATES, INC. (MCA). IT IS TO BE USED ONLY FOR THE PROJECT AND SITE SPECIFICALLY IDENTIFIED HEREON. NO PART OF THIS DRAWING IS TO BE REPRODUCED, COPIED, OR TRANSMITTED IN ANY FORM OR BY ANY MEANS, ELECTRONIC OR MECHANICAL, INCLUDING PHOTOCOPYING, RECORDING, OR BY ANY INFORMATION STORAGE AND RETRIEVAL SYSTEM, WITHOUT THE WRITTEN PERMISSION OF MCA. ANY UNAUTHORIZED USE OF THIS DRAWING IS STRICTLY PROHIBITED.

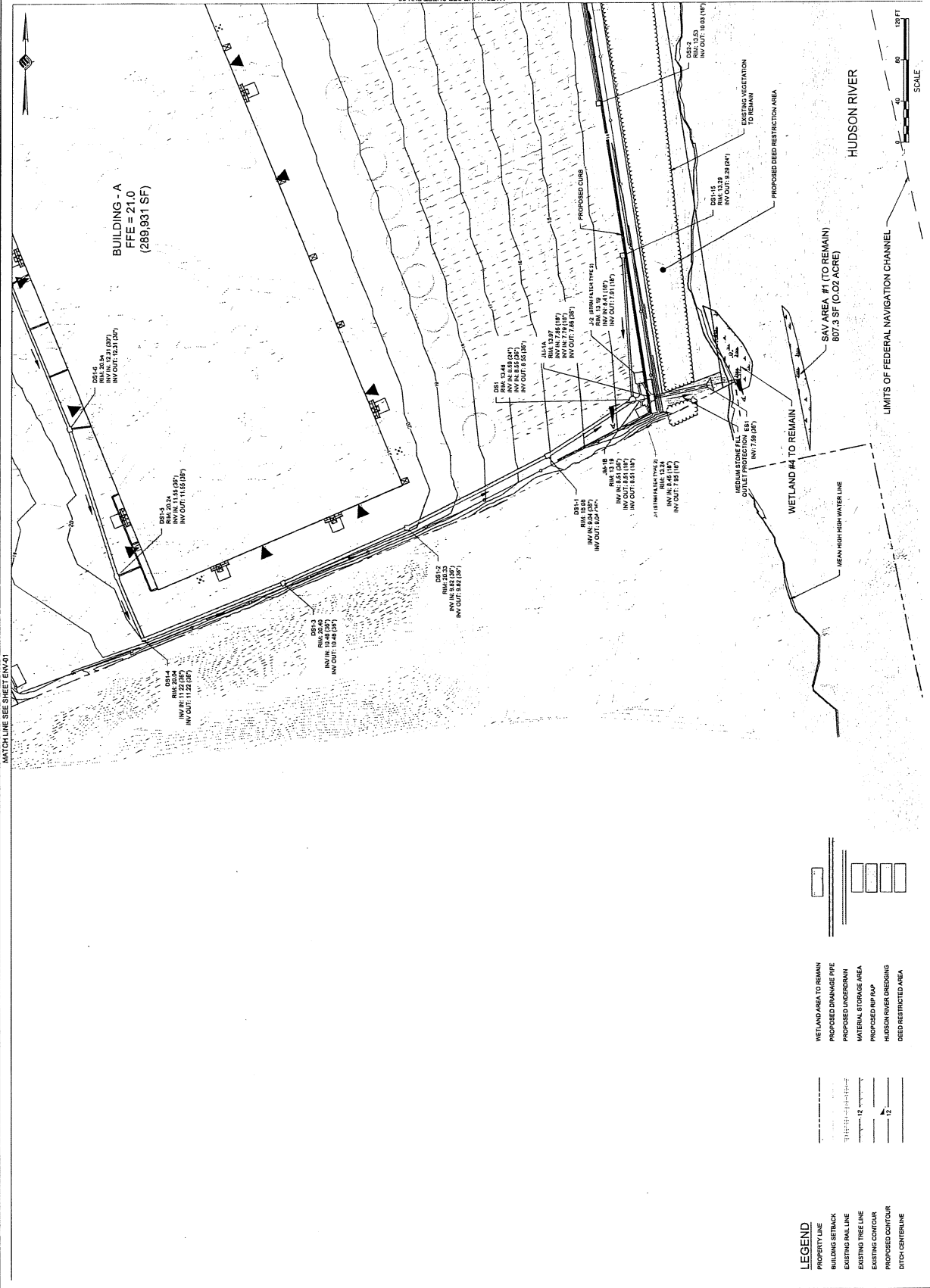

MATCH LINE SEE SHEET ENV-01

MATCH LINE SEE SHEET ENV-05

LEGEND

	PROPERTY LINE
	BUILDING SETBACK
	EXISTING PAIL LINE
	EXISTING TREE LINE
	EXISTING CONTOUR
	PROPOSED CONTOUR
	DITCH CENTRELINE
	WETLAND AREA TO REMAIN
	PROPOSED DRAINAGE PIPE
	PROPOSED UNDERDRAIN
	MATERIAL STORAGE AREA
	PROPOSED RIP RAP
	HUDSON RIVER UNDERPASS
	DEED RESTRICTED AREA



McFarland Johnson
 50 WALTON PLACE
 SARATOGA SPRINGS, NEW YORK 12866
 P: 518-583-3300 F: 518-583-3383
 cm@mcfarlandjohnson.com

PROJECT: ALBANY PORT DISTRICT COMMISSION

NO.	DATE	DESCRIPTION

CLIENT: ALBANY PORT DISTRICT COMMISSION
 PROJECT: ALBANY, NEW YORK
 PORT OF ALBANY EXPANSION SITE

DRAWN	AEJ
DESIGNED	RSD
CHECKED	AJF
SCALE	1"=40'
DATE	MAY 2022
PROJECT	19841.00

ENVIRONMENTAL PLAN
 DRAWING NUMBER: ENV-05
 7 OF 18

ALBANY PORT DISTRICT COMMISSION
 PORT OF ALBANY EXPANSION SITE
 ENVIRONMENTAL PLAN
 DRAWING NUMBER: ENV-05
 7 OF 18

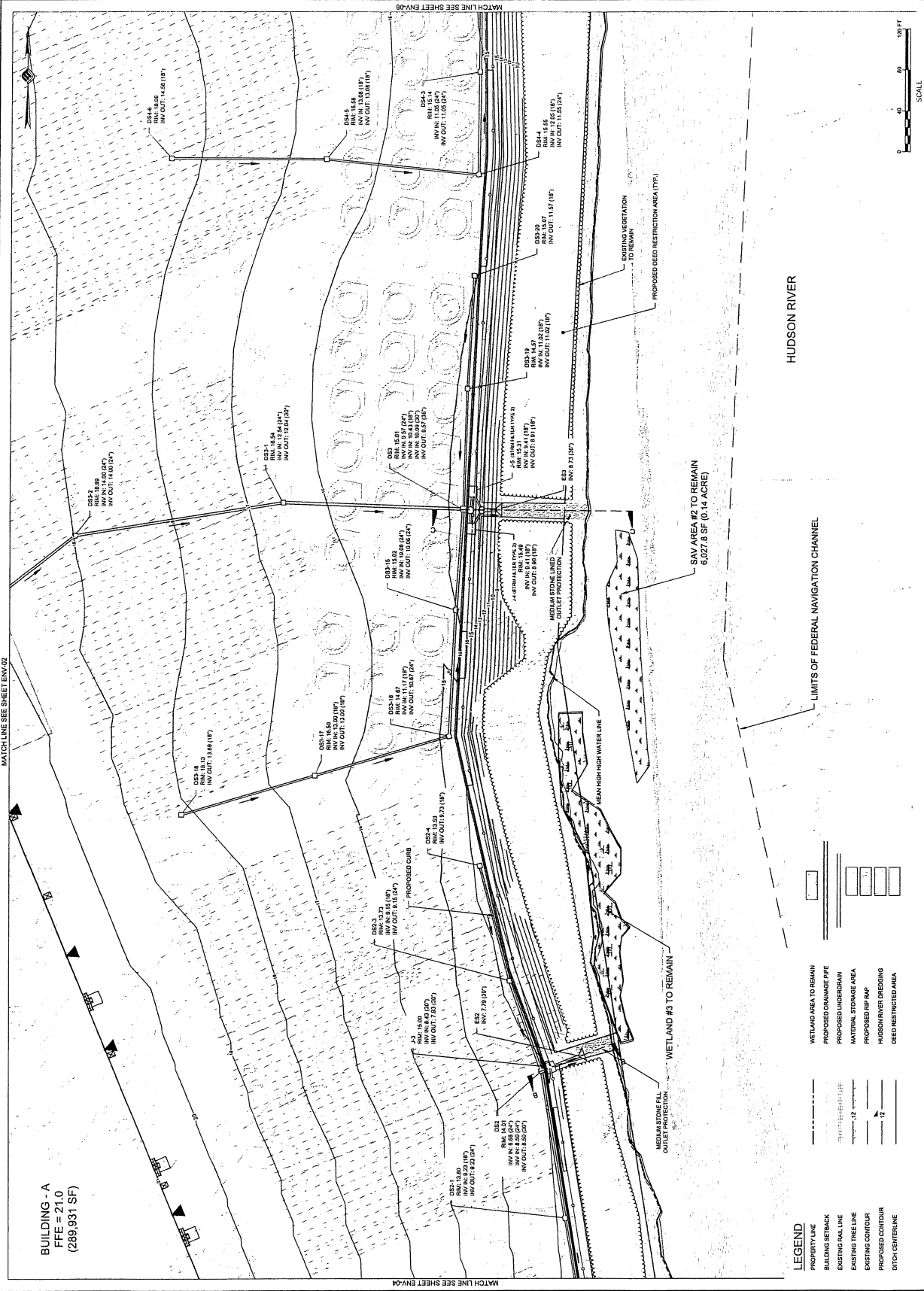

BUILDING - A
 FFE = 21.0
 (289,937 SF)

LEGEND
 PROPERTY LINE
 BUILDING SETBACK
 EXISTING PAWL LINE
 EXISTING TREE LINE
 EXISTING CONTOUR
 DITCH CENTERLINE
 WETLAND AREA TO REMAIN
 PROPOSED DRAINAGE PIPE
 PROPOSED UNDERDRAIN
 MATERIAL STORAGE AREA
 PROPOSED RMP RAP
 HUDSON RIVER CROSSING
 DEED RESTRICTED AREA

REV	DATE	DESCRIPTION

CLIENT: ALBANY PORT DISTRICT COMMISSION
 PROJECT: ALBANY, NEW YORK
 PORT OF ALBANY EXPANSION SITE

DRAWN: JES
 DESIGNED: HSD
 CHECKED: AJP
 SCALE: 1"=40'
 DATE: MAY 2022
 PROJECT: 18641.00

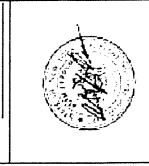

ENVIRONMENTAL PLAN
 DRAWING NUMBER: ENV-06
 SHEET 6 OF 16

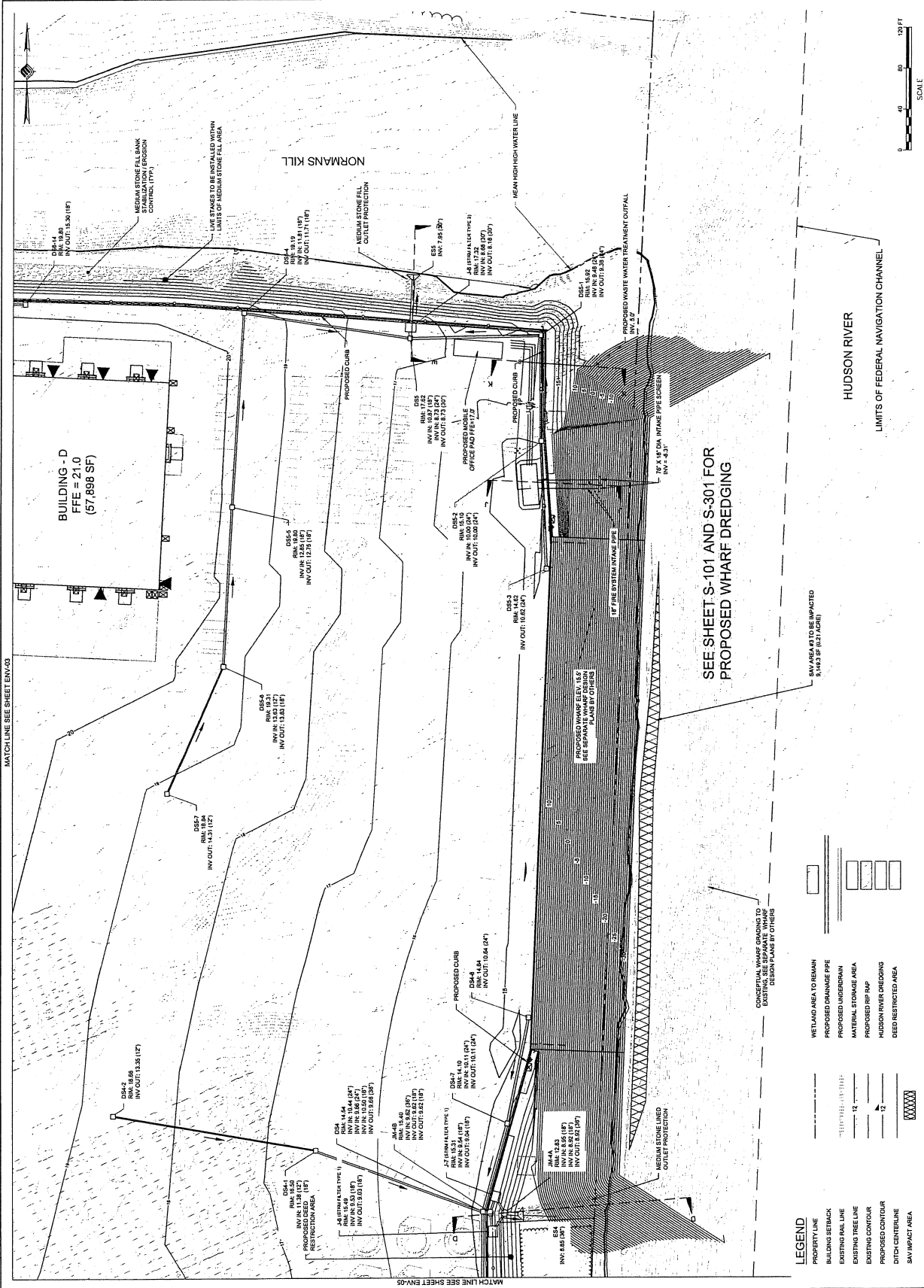

SEE SHEET S-101 AND S-301 FOR PROPOSED WHARF DREDGING

- LEGEND**
- WETLAND AREA TO REMAIN
 - PROPOSED DRAINAGE PIPE
 - PROPOSED UNDERDRAIN
 - MAXIMUM STORAGE AREA
 - PROPOSED RIP RAP
 - HUDSON RIVER DREDGING
 - DEED RESTRICTED AREA
 - PROPERTY LINE
 - BUILDING SETBACK
 - EXISTING RAIL LINE
 - EXISTING TREE LINE
 - EXISTING CONTOUR
 - PROPOSED CONTOUR
 - DITCH CENTERLINE
 - SAW IMPACT AREA

NO.	DATE	DESCRIPTION
1	01/27/21	ISSUED FOR PERMIT

PROJECT: ALBANY PORT DISTRICT COMMISSION

CLIENT: ALBANY, NEW YORK

PROJECT: ALBANY PORT DISTRICT COMMISSION

DESIGNED	JMS
CHECKED	AFD
SCALE	1" = 40'
DATE	MAY 2021
PROJECT	18841.00

SECTION VIEWS
 DRAWING NUMBER: XS-01
 10 OF 18

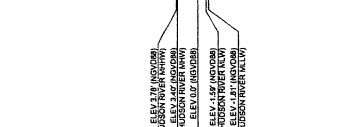
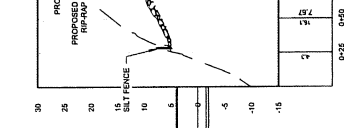
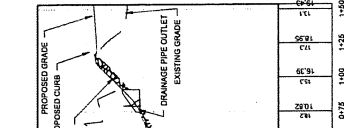
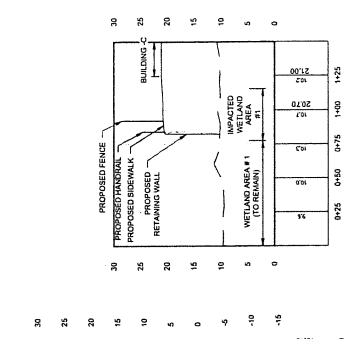
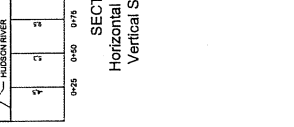
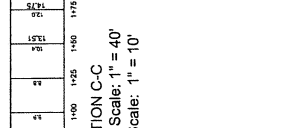
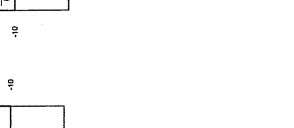
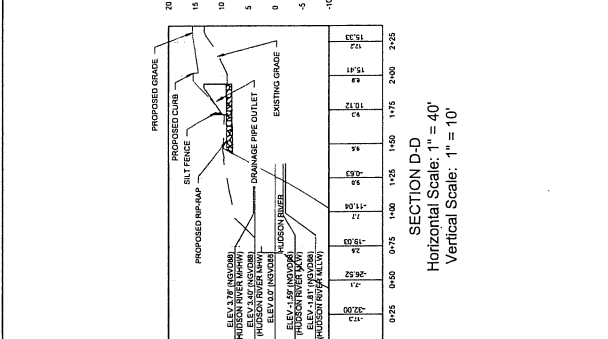

ALBANY PORT DISTRICT COMMISSION
 WETLAND AREA #1
 ELEVATIONS (INDICATED)
 PROPOSED CURB
 PROPOSED RIP-RAP
 PROPOSED SILT FENCE
 PROPOSED DRAINAGE PIPE
 PROPOSED DRAINAGE PIPE OUTLET
 EXISTING GRADE
 PROPOSED GRADE

McFarland Johnson
 69 RAUL ROAD PLACE
 SARATOGA SPRINGS, NEW YORK 12086
 P: 518-580-9380 F: 518-580-9383
 Saratoga@mcjinc.com

NO.	DATE	DESCRIPTION

CLIENT: ALBANY PORT DISTRICT COMMISSION
 PROJECT: ALBANY, NEW YORK
 PORT OF ALBANY EXPANSION SITE

DRAWN	JES
DESIGNED	RSD
CHECKED	AJF
SCALE	1"=40'
DATE	MAY 2022
PROJECT	06A1100

SECTION VIEWS
 DRAWING NUMBER
 XS-02
 OF 18

PERMIT SKETCHES

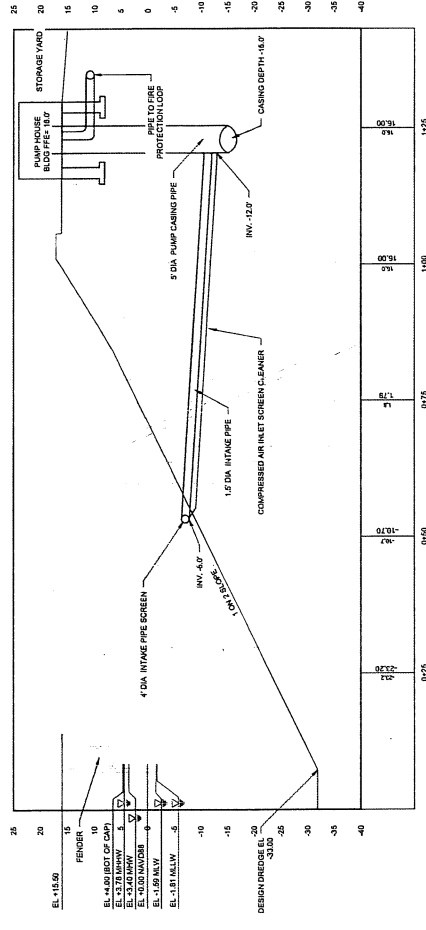

SECTION J-J
 Horizontal Scale: 1" = 10'
 Vertical Scale: 1" = 10'

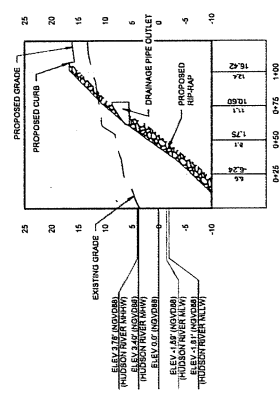

WASTE WATER TREATMENT PLANT OUTFALL (K-K)
 Horizontal Scale: 1" = 40'
 Vertical Scale: 1" = 10'

McFarland Johnson
 CIVIL ENGINEERS
 350 NORTH PLAZA
 SUITE 202
 SARATOGA SPRINGS, NEW YORK, 12866
 P: 518-585-7665 F: 518-860-9387
 saratoga@mcj.com

NO.	DATE	DESCRIPTION

PROJECT MILESTONE
PERMIT SKETCHES

CLIENT: ALBANY PORT DISTRICT COMMISSION
 ALBANY, NEW YORK
 PORT OF ALBANY SITE IMPROVEMENTS

DESIGNED	SJM
CHECKED	JLR
SCALE	1" = 20'
DATE	MAY 2022
PROJECT	1943.00

BRIDGE GENERAL PLAN
 DRAWING NUMBER: ST-01
 SCALE: 1" OF 4'

LEGEND

--- SF	SILT FENCE
----- TC	TURBIDITY CURTAIN
+++++	PROPERTY LINE
---	EXISTING RAIL LINE
----	EXISTING TREE LINE
-----	DITCH CENTERLINE
-----	ROADSIDE SWALE
/////	WETLAND AREA PERMANENT IMPACTS

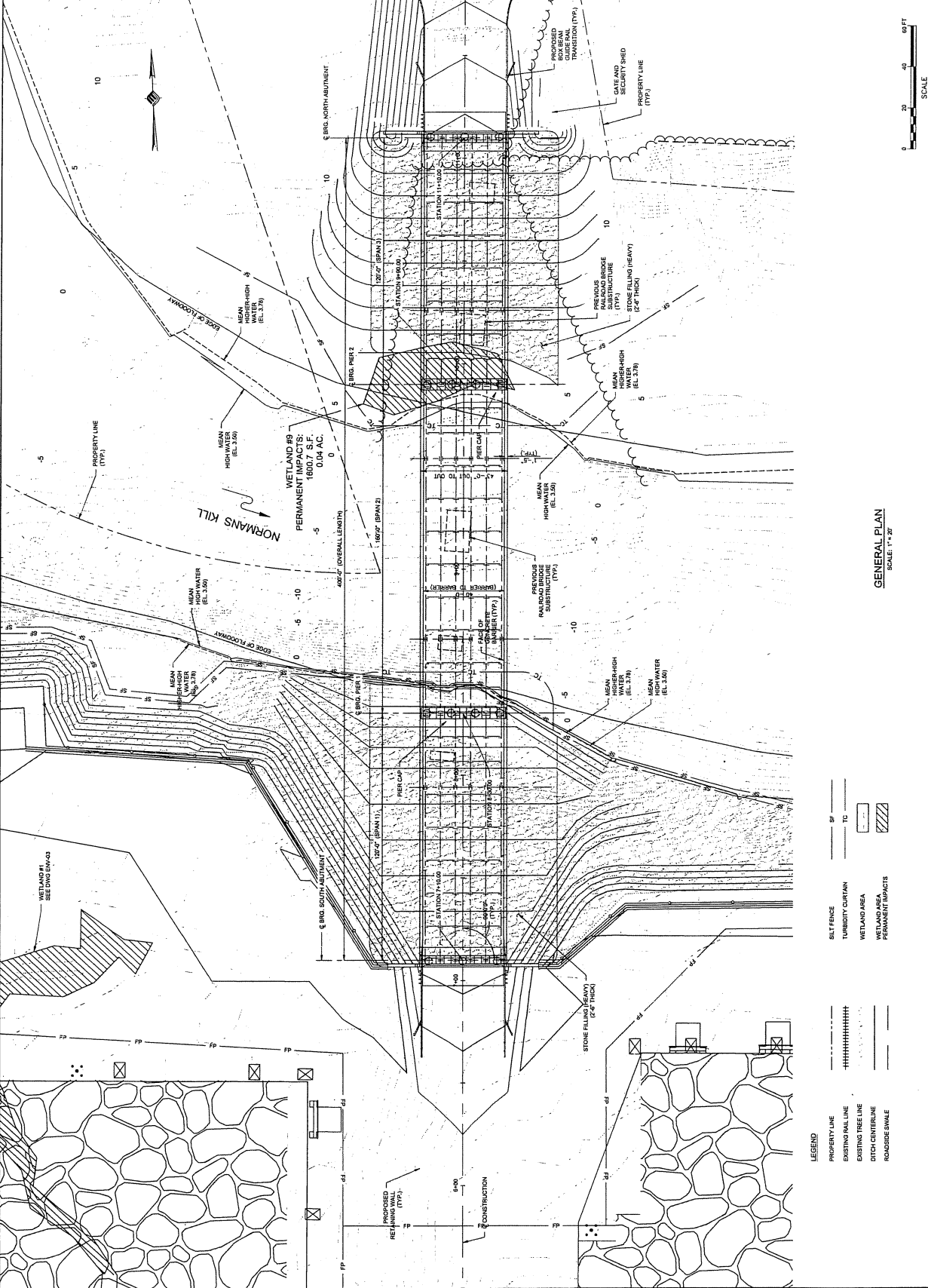



PROJECT MILESTONE
 PERMIT SKETCHES
 DATE: 06/28/2024

CLIENT: ALBANY PORT DISTRICT COMMISSION
 PROJECT: ALBANY, NEW YORK
 PORT OF ALBANY SITE INFRASTRUCTURE IMPROVEMENTS

DRAWN: SJA
 CHECKED: JAF
 SCALE: 1/4" = 1'-0"
 DATE: JULY 2024
 PROJECT: 18461.00

NOTE:
 1. FINAL BRIDGE GRADING AND LIMITS AND TYPE OF SECUR...
 PROTECTIVE CURBS, SIDEWALKS, AND PAVEMENTS TO BE DEVELOPED...
 CONSTRUCTION CONTRACT.

DRAWING TITLE: BRIDGE PROFILE
 DRAWING NUMBER: ST-03
 3 OF 4

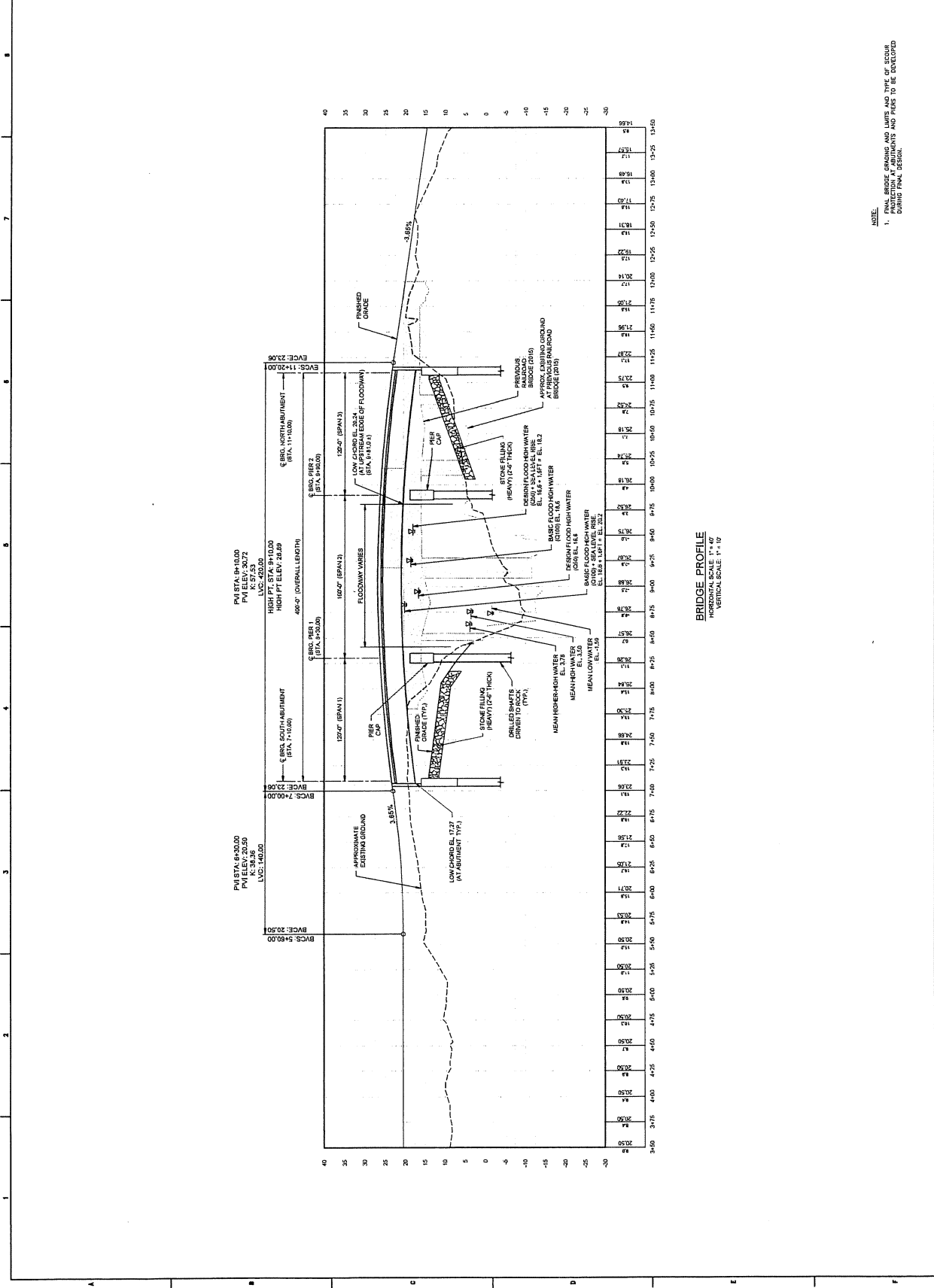

PERMIT SKETCHES

NO.	DATE	DESCRIPTION

ALBANY PORT DISTRICT COMMISSION
 ALBANY, NEW YORK
 PROJECT: **PORT OF ALBANY EXPANSION SITE**

DRAWN	JRE
DESIGNED	KMD
CHECKED	JAF
SCALE	1"=10'
DATE	JULY 2021
PROJECT	YBA10R

EROSION AND SEDIMENT CONTROL DETAILS

ESC-06

17 OF 18

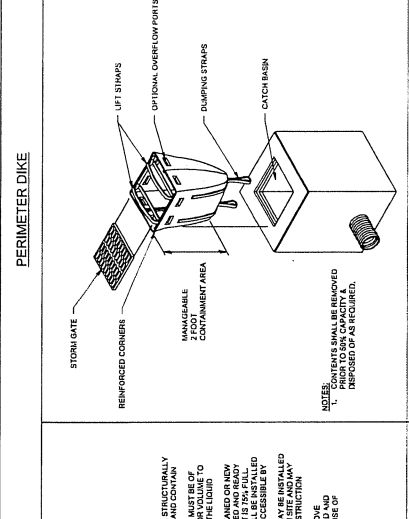
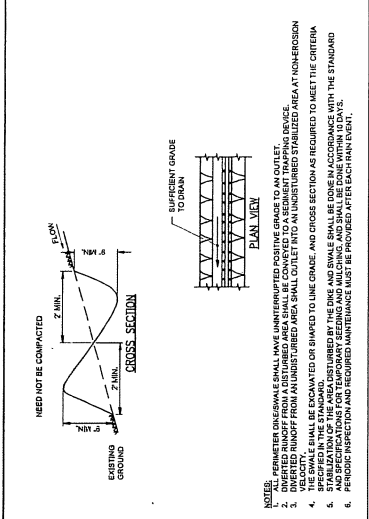

PERIMETER DIKE

NOTES:
 1. ALL PERIMETER DIKES SHALL HAVE UNINTERRUPTED POSITIVE GRADE TO AN OUTLET.
 2. DRAINAGE RUNOFF FROM AN UNDRIVER AREA SHALL OUTLET INTO AN UNDRIVER STARLINED AREA AT NON-EROSION
 3. THE SWALE SHALL BE EXCAVATED OR SHAPED TO THE GRADE, AND CROSS SECTION AS REQUIRED TO MEET THE CRITERIA
 4. STABILIZATION OF THE CANAL DISTURBED BY THE DIKE AND SWALE SHALL BE DONE IN ACCORDANCE WITH THE STANDARD
 5. AND SPECIFICATIONS FOR TEMPORARY SEEDING AND MULCHING, AND SHALL BE DONE WITHIN 180 DAYS.
 6. PERIODIC INSPECTION AND REPAIRS AND MAINTENANCE SHALL BE PROVIDED AFTER EACH RAIN EVENT.

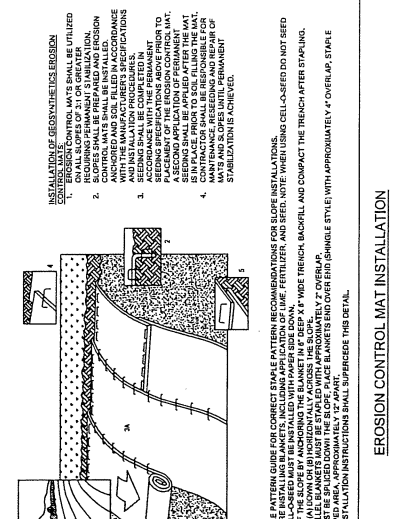

INLET PROTECTION

INSTALLATION OF GEOTEXTILES EROSION CONTROL MATS SHALL BE UTILIZED FOR ALL SLOPES OF 2:1 OR GREATER. SLOPES SHALL BE PREPARED AND REGION UNDESIGNED AND SOIL FILLED IN ACCORDANCE WITH THE MANUFACTURER'S SPECIFICATIONS. SECOND SHALL BE COMPLETED IN ACCORDANCE WITH THE MANUFACTURER'S SPECIFICATIONS ABOVE PRIOR TO A SECOND APPLICATION OF PERMANENT SEEDING AND MULCHING. PERMANENT SEEDING SHALL BE RESPONSIBLE FOR PROTECTING THE CHANNEL FROM SCOUR AND SLOPES UNTIL PERMANENT STABILIZATION IS ACHIEVED.

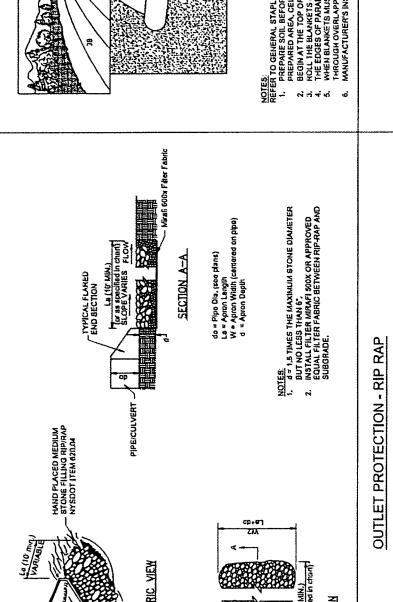
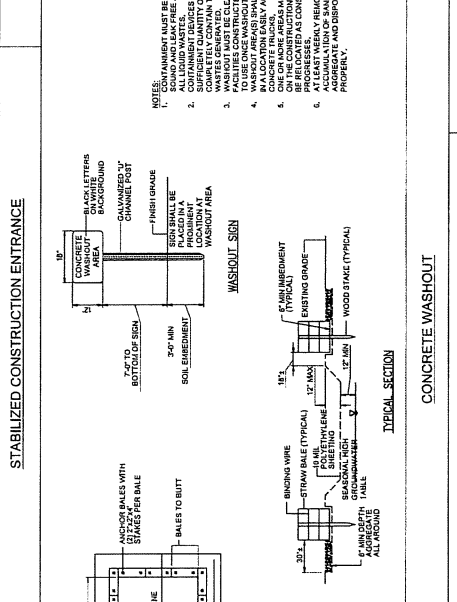
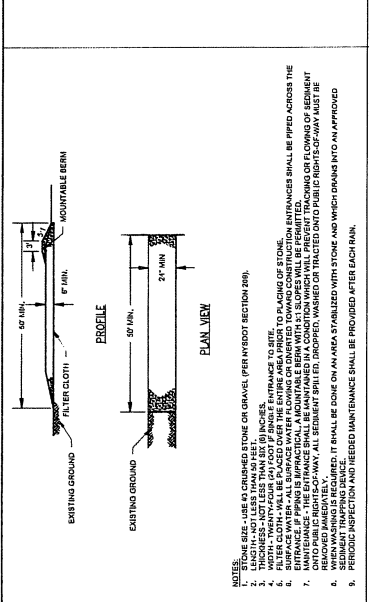

OUTLET PROTECTION - RIP RAP

NOTES:
 1. RIP RAP SHALL BE PLACED ON A 6" THICK GRANULAR SUBGRADE.
 2. RIP RAP SHALL BE PLACED IN A CHANNEL WITH A MINIMUM WIDTH OF 6' AND A DEPTH OF 6'.
 3. RIP RAP SHALL BE PLACED IN A CHANNEL WITH A MINIMUM SLOPE OF 1:1.
 4. RIP RAP SHALL BE PLACED IN A CHANNEL WITH A MINIMUM SLOPE OF 1:1.
 5. RIP RAP SHALL BE PLACED IN A CHANNEL WITH A MINIMUM SLOPE OF 1:1.

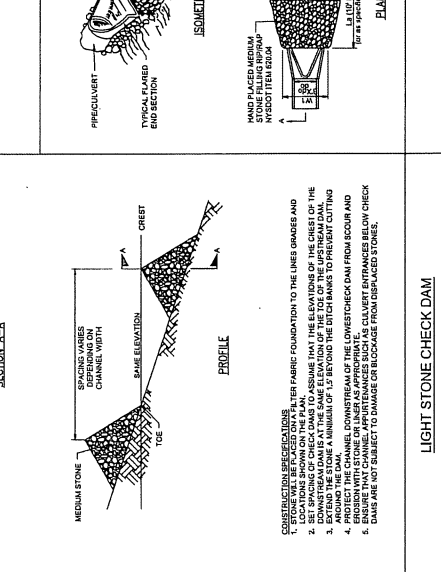
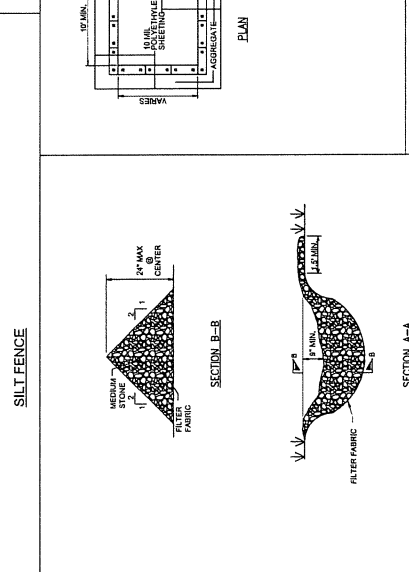
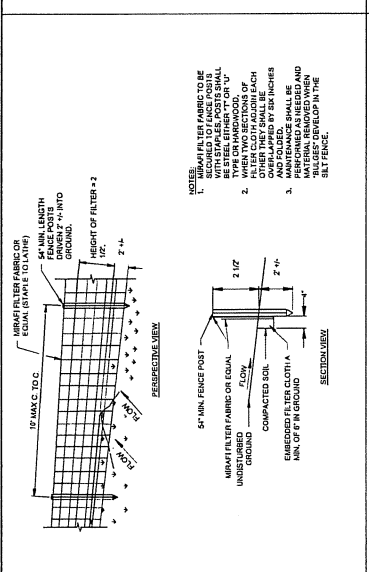

LIGHT STONE CHECK DAM

NOTES:
 1. CHECK DAMS SHALL BE CONSTRUCTED WITH STONE AND NOT BAGGED MATERIAL.
 2. CHECK DAMS SHALL BE PLACED AT DOWNSTREAM ENDS OF CHANNELS.
 3. CHECK DAMS SHALL BE PLACED AT DOWNSTREAM ENDS OF CHANNELS.
 4. CHECK DAMS SHALL BE PLACED AT DOWNSTREAM ENDS OF CHANNELS.
 5. CHECK DAMS SHALL BE PLACED AT DOWNSTREAM ENDS OF CHANNELS.

- NOTES:
1. THE AREA UNDER EMBANKMENT SHALL BE CLEARED, GRUBBED AND STRIPPED OF ANY VEGETATION AND ROOT MAT. THE FLOOD AREA SHALL BE FILLED WITH FILL TO THE FINISHED ELEVATION. THE FILL SHALL BE COMPACTED TO THE FINISHED ELEVATION. THE EMBANKMENT SHALL BE CONSTRUCTED WITH A MINIMUM OF 10% OVERSIZED STONES. ROCKS, ORGANIC MATERIAL, OR OTHER UNSUITABLE MATERIAL SHALL NOT BE USED.
 2. THE STONE USED IN THE OUTLET SHALL BE SMALL PERHAP 4" TO 6" IN DIAMETER. THE STONE SHALL BE PLACED IN THE UP-GRABE SIDE ON THE SMALL UPRAV OR EMBEDDED FILTER.
 3. THE SEDIMENT SHALL BE REMOVED AND TRAP RESTORED TO ITS ORIGINAL DIMENSIONS WHEN THE SEDIMENT HAS ACCUMULATED TO A DEPTH OF 18" TO 24".
 4. THE SEDIMENT SHALL BE INSPECTED AFTER EACH RAIN AND REPAIRS MADE AS NEEDED.
 5. THE SEDIMENT SHALL BE REMOVED AND THE AREA STABILIZED WITH MULCH OR GRASS SEED.
 6. THE MAXIMUM DRAINAGE AREA IS 8.5 ACRES.

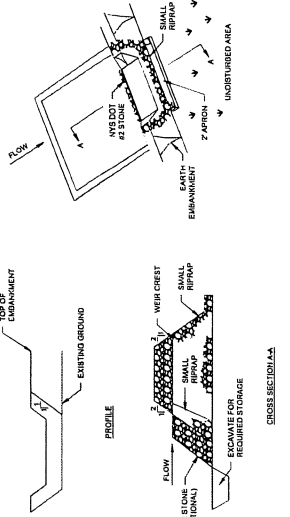

STONE OUTLET SEDIMENT TRAP

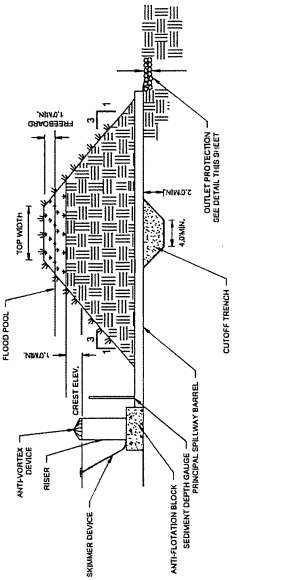

SEDIMENT BASIN

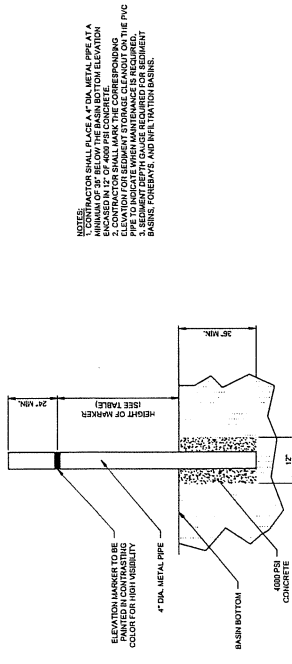

SEDIMENT DEPTH GAUGE

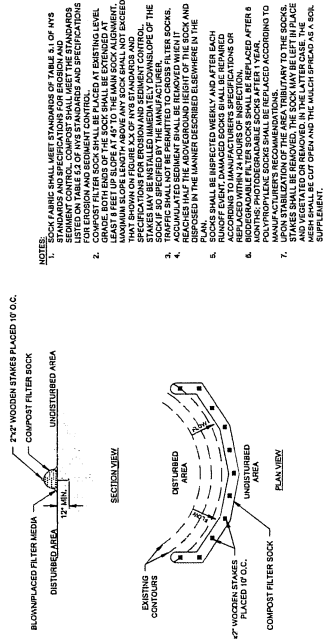

SEDIMENT FILTER SOCK

NOTES:

1. THE SEDIMENT SHALL BE REMOVED AND TRAP RESTORED TO ITS ORIGINAL DIMENSIONS WHEN THE SEDIMENT HAS ACCUMULATED TO A DEPTH OF 18" TO 24".
2. THE SEDIMENT SHALL BE INSPECTED AFTER EACH RAIN AND REPAIRS MADE AS NEEDED.
3. THE SEDIMENT SHALL BE REMOVED AND THE AREA STABILIZED WITH MULCH OR GRASS SEED.
4. THE MAXIMUM DRAINAGE AREA IS 8.5 ACRES.

SEDIMENT BASIN

NOTES:

1. THE SEDIMENT SHALL BE REMOVED AND TRAP RESTORED TO ITS ORIGINAL DIMENSIONS WHEN THE SEDIMENT HAS ACCUMULATED TO A DEPTH OF 18" TO 24".
2. THE SEDIMENT SHALL BE INSPECTED AFTER EACH RAIN AND REPAIRS MADE AS NEEDED.
3. THE SEDIMENT SHALL BE REMOVED AND THE AREA STABILIZED WITH MULCH OR GRASS SEED.
4. THE MAXIMUM DRAINAGE AREA IS 8.5 ACRES.

SEDIMENT DEPTH GAUGE

NOTES:

1. THE SEDIMENT SHALL BE REMOVED AND TRAP RESTORED TO ITS ORIGINAL DIMENSIONS WHEN THE SEDIMENT HAS ACCUMULATED TO A DEPTH OF 18" TO 24".
2. THE SEDIMENT SHALL BE INSPECTED AFTER EACH RAIN AND REPAIRS MADE AS NEEDED.
3. THE SEDIMENT SHALL BE REMOVED AND THE AREA STABILIZED WITH MULCH OR GRASS SEED.
4. THE MAXIMUM DRAINAGE AREA IS 8.5 ACRES.

SEDIMENT FILTER SOCK

File: Q:\NY10949-01\20 CAD\DDL_Active\Permits\1094901P-01_Plot.txd: 7/15/2021 8:44 AM by WILKINSON, MELISSA; Saved: 7/14/2021 3:05 PM by MWILKINSON

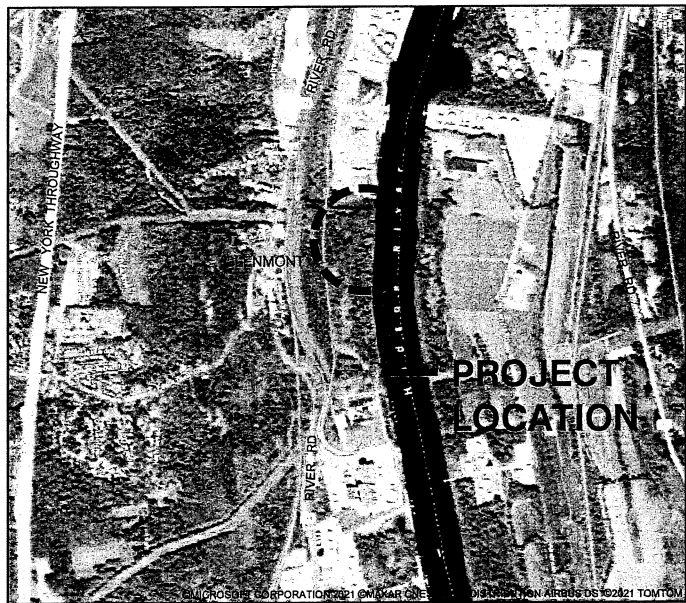
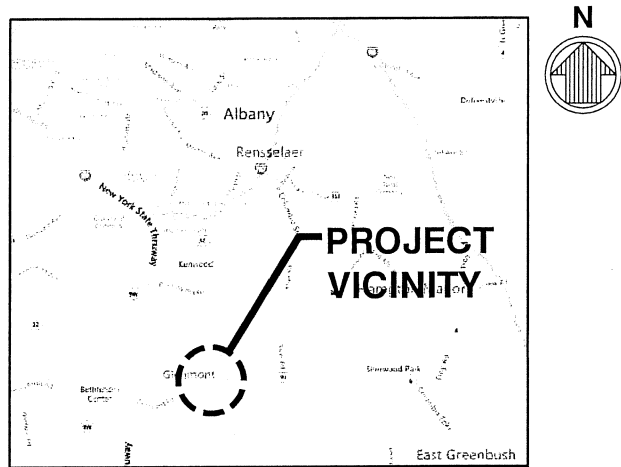

VICINITY AND LOCATION MAP
SCALE: N.T.S.

NOTES:

1. HORIZONTAL CONTROL REFERENCED TO NORTH AMERICAN DATUM OF 1983, STATE PLANE COORDINATE SYSTEM, NEW YORK, EAST ZONE, IN FEET.
2. WATER LEVEL DATUM IS BASED ON NATIONAL GEODETIC VERTICAL DATUM OF 1929, AS FOLLOWS:
 - MEAN HIGHER HIGH WATER LEVEL (MHHW) +4.56 FT (NGVD29)
 - MEAN HIGH WATER LEVEL (MHW) = +4.18 FT (NGVD29)
 - MEAN TIDE LEVEL (MTL) = +1.69 FT (NGVD29)
 - MEAN LOW WATER LEVEL (MLW) = -0.80 FT (NGVD29)

PURPOSE: WHARF CONSTRUCTION
 PERMIT SUBMITTAL-NOT TO BE USED
 FOR CONSTRUCTION
 DATUM: NGVD29



m & n engineering, p.c.

OWNER/APPLICANT:
 ALBANY PORT DISTRICT COMMISSION
 PORT OF ALBANY

IN: HUDSON RIVER
 NEAR: SOUTH OF ALBANY

LOCATION: PORT OF ALBANY
 106 SMITH BOULEVARD
 ALBANY, NEW YORK 12202

WHARF DREDGING AND CONSTRUCTION

VICINITY AND LOCATION

DATE: 2021-07-15

File: Q:\IN\10949-0120 CADD\Active\Permis1094901P-02; Plotted: 7/15/2021 8:44 AM by WILKINSON, MELISSA; Saved: 7/14/2021 3:22 PM by MWILKINSON

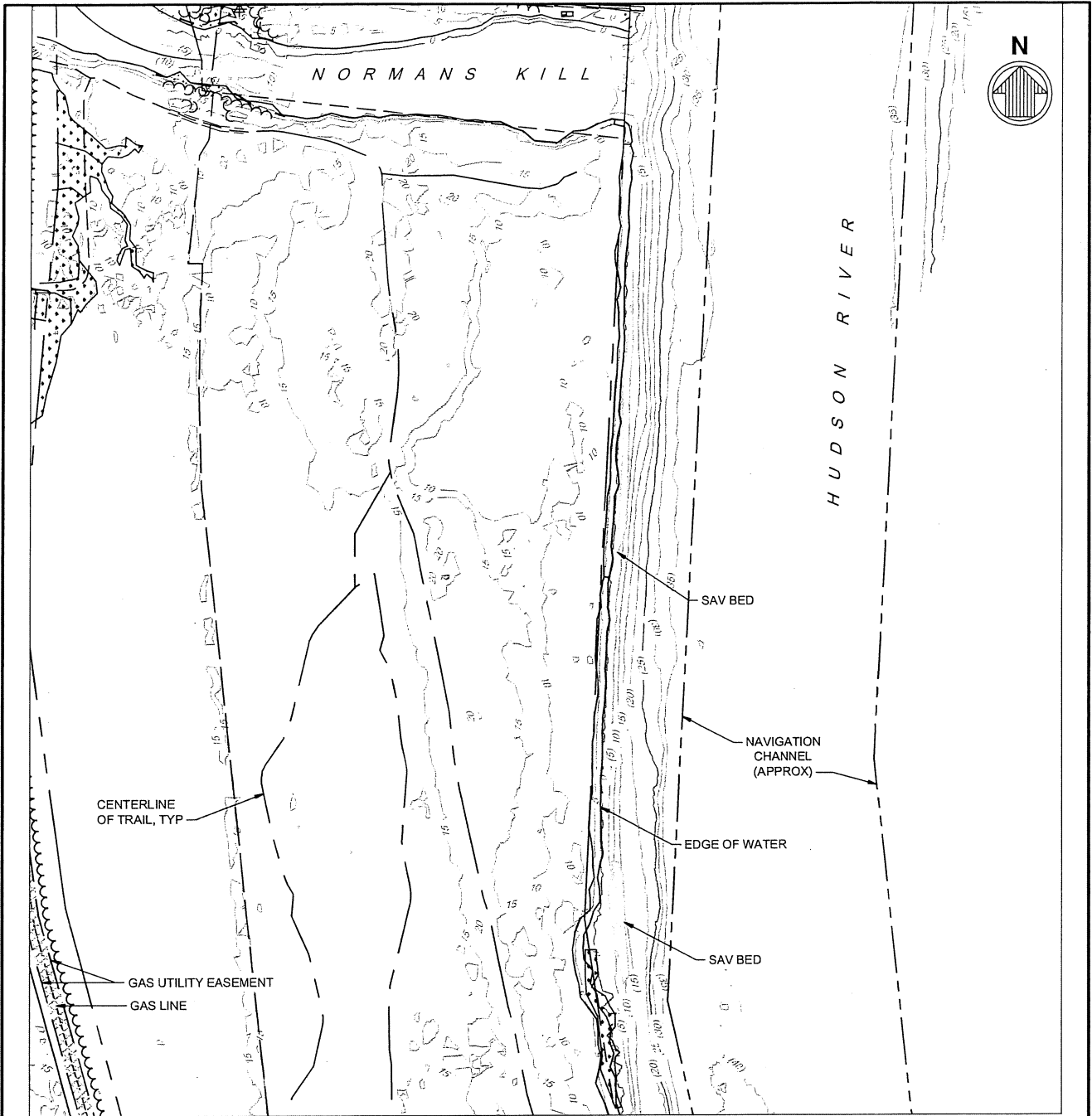

PLAN - EXISTING CONDITIONS

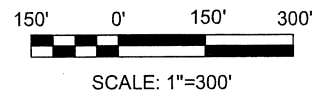

PURPOSE: WHARF CONSTRUCTION
 PERMIT SUBMITTAL-NOT TO BE USED
 FOR CONSTRUCTION
 DATUM: NGVD29



m & n engineering, p.c.

OWNER/APPLICANT:
 ALBANY PORT DISTRICT COMMISSION
 PORT OF ALBANY

IN: HUDSON RIVER
 NEAR: SOUTH OF ALBANY

LOCATION: PORT OF ALBANY
 106 SMITH BOULEVARD
 ALBANY, NEW YORK 12202

WHARF DREDGING AND CONSTRUCTION

PLAN - EXISTING CONDITIONS

DATE: 2021-07-15



DATE	DESCRIPTION

PLAN - GENERAL
ARRANGEMENT

MARINE FACILITIES ON THE PORT OF
ALBANY EXPANSION

229 NORTH AVENUE, 14TH FLOOR
ALBANY, NY 12202
m+n engineering, p.c.
212.764.7154
WWW.MNENGIN.COM

ALBANY PORT DISTRICT COMMISSION
ALBANY, NY 12202
PLAN NO. 100-69-01
DATE: MAY 2021

Sheet Reference No.
S-101
INDEX 1 OF 2

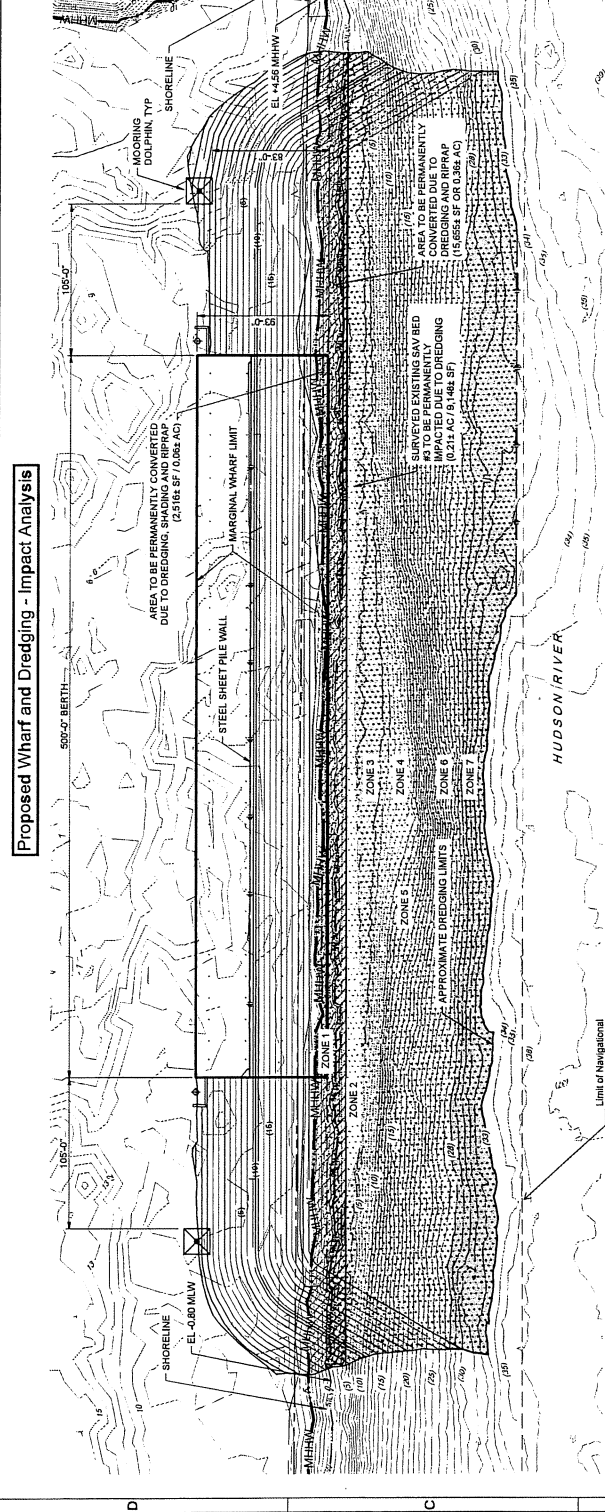

A1 PLAN - GENERAL ARRANGEMENT
SCALE: 1" = 40'

LEGEND:

- (22) EXISTING CONTOURS
- (33) PROPOSED CONTOURS
- EXISTING MEAN HIGHER HIGH WATER
- PROPOSED DREDGING
- [Pattern] DREDGING, SHADING AND RIPRAP IMPACTS
- [Pattern] DREDGING AND RIPRAP IMPACTS

EXISTING ELEVATIONS (FEET)	HABITAT OF CONCERN	MAIN IMPACTS / HABITAT CONVERSION (ACRES)		
		DREDGING	SHADING	RIPRAP
1 SEE LEGEND	INTERTIDAL ZONE AND SHORE STRUCTURES	0.25	0.06	0.25
2	SAV BED #2 (SPARSE LOW DENSITY)	0.21		0.05
3	NATURAL RIVER BOTTOM (SILT CLAY, SAND AND SOME TRACE OF GRAVEL)	0.34		0.12
4	NATURAL RIVER BOTTOM (SILT CLAY, SAND AND SOME TRACE OF GRAVEL)	0.24		
5	NATURAL RIVER BOTTOM (SILT CLAY, SAND AND SOME TRACE OF GRAVEL)	0.24		
6	NATURAL RIVER BOTTOM (SILT CLAY, SAND AND SOME TRACE OF GRAVEL)	0.78		
7	NATURAL RIVER BOTTOM (SILT CLAY, SAND AND SOME TRACE OF GRAVEL)	0.55		
	TOTAL (ACRES):	2.62	0.06	0.42

NOTES:

- ZONE 1 INCLUDES SHADING AND RIPRAP AREAS.
- ZONES 2-7 INCLUDES 2' ALLOWABLE OVERDREDGE.
- ELEVATION DATUM: NAVD83.

PLEASE ADVISE THE ENVIRONMENTAL ENGINEER IMMEDIATELY BY PERSONAL CALLS (518) 462-2200 OR BY FAX (518) 462-2201 IF YOU BELIEVE THAT THE ALBANY PORT DISTRICT COMMISSION HAS BEEN IMPACTED BY ANY WAY OF AN UNDESIRABLE MANNER. THE ALBANY PORT DISTRICT COMMISSION WILL BE RESPONSIBLE FOR THE COST OF ANY INVESTIGATION AND A SPECIFIC DESCRIPTION OF SUCH ALTERATION.

Proposed Wharf and Dredging - Impact Analysis

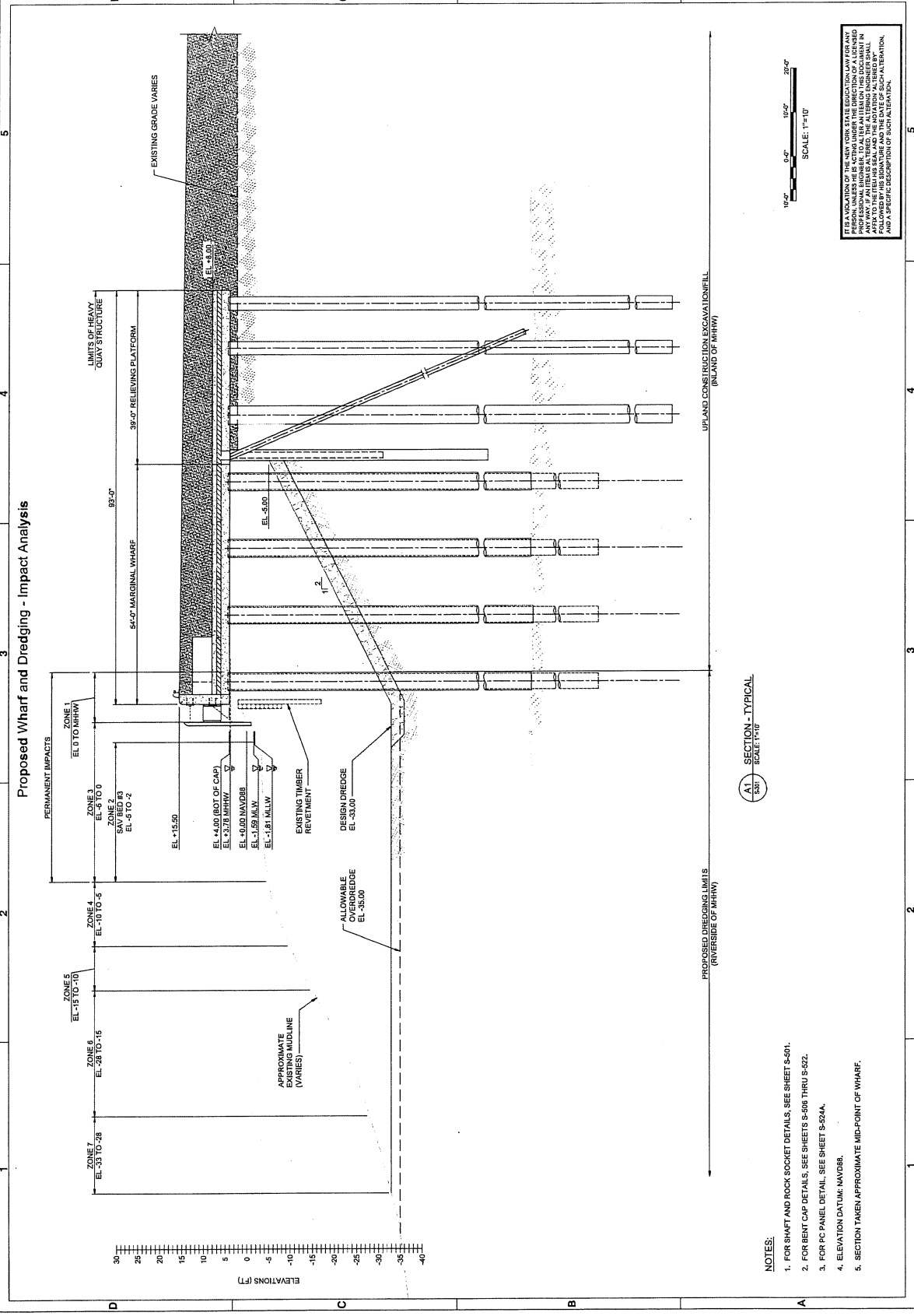

No.	Description	Date

SECTION - TYPICAL
HEAVY LIFT QUAY/WHARF

DESIGNED BY: M.A. ENGINEERING, P.C. NEW YORK, NY 10017 DATE: 04/2022	CHECKED BY: M.A. ENGINEERING, P.C. NEW YORK, NY 10017 DATE: 04/2022	DATE: 04/2022
PROJECT NO.: 21-0948-01	PROJECT NAME: PORT OF ALBANY	PROJECT LOCATION: ALBANY, NY

PORT - ALBANY
ALBANY PORT DISTRICT COMMISSION
100 SOUTH ALBANY, NY 12202

INDEX: 2 OF 2
SHEET REFERENCE NO.

NOTES:
1. FOR SHaft AND ROCK SOCKET DETAILS, SEE SHEET S-601.
2. FOR BENT CAP DETAILS, SEE SHEETS S-508 THRU S-522.
3. FOR PC PANEL DETAIL, SEE SHEET S-524A.
4. ELEVATION DATUM: NAVD83.
5. SECTION TAKEN APPROXIMATE MID-POINT OF WHARF.

SCALE: 1"=10'
10'-0" 0'-0" 10'-0" 20'-0"

SECTION - TYPICAL
SCALE: 1"=10'

PROPOSED DREDGING LIMITS (RIVERSIDE OF MHHW)
UPLAND CONSTRUCTION EXCAVATION/FILL (INLAND OF MHHW)

PERMANENT IMPACTS
ZONE 1 EL.0 TO XHHW
ZONE 2 EL.-5 TO 0
ZONE 3 SAN BED #3 EL.-5 TO -2
ZONE 4 EL.-10 TO -5
ZONE 5 EL.-15 TO -10
ZONE 6 EL.-20 TO -15
ZONE 7 EL.-25 TO -20

EL. +15.50
EL. +15 (BOT OF CAP)
EL. +12 (TYPICAL)
EL. +10 NAVD83
EL. +9.81 MLLW
EXISTING TIMBER REVETMENT
DESIGN DREDGE EL.-33.00
ALLOWABLE DREDGE EL.-35.00

APPROXIMATE MIDLINE (VARIES)
EXISTING GRADE VARIES

ELEVATIONS (FT)
30
25
20
15
10
5
0
-5
-10
-15
-20
-25
-30
-35
-40